



DAUGHTERS OF THE REPUBLIC OF TEXAS

LEGATION MEMORIAL
WASHINGTON, D. C.

CONTENTS

SITE OVERVIEW AND CONTEXT

- 4-5 SITE OVERVIEW AND CONTEXT: LOCATION
- 6 SITE OVERVIEW AND CONTEXT: PHOTOS
- 7 EXISTING SITE CONTEXT: MEMORIALS & SCULPTURES
- 8 SITE ELEMENTS: SITE CONTEXT
- 9 SITE OVERVIEW AND CONTEXT: EXISTING LANDSCAPE
- 10 DOCUMENTED HISTORICAL LOCATIONS ASSOCIATED WITH THE REPUBLIC OF TEXAS LEGATION TO THE US
- 11 SITE OVERVIEW AND CONTEXT: SITE PLAN
- 12 SITE OVERVIEW AND CONTEXT: EXISTING CONDITIONS

MEMORIAL DESIGN

- 14 EXISTING CONDITIONS AERIAL VIEW
- 15 EXISTING CONDITIONS SITE PLAN
- 16 DESIGN CONCEPT: PLANS AND RENDERING
- 17 DESIGN CONCEPT: ELEVATION
- 18 DESIGN CONCEPT: SECTION
- 19 DESIGN CONCEPT: MATERIALS
- 20 DESIGN CONCEPT: MEMORIAL ENGRAVING TEXT SIZE DETAIL

LANDSCAPE DESIGN

- 22 EXISTING CONDITIONS: SOLAR STUDIES
- 23 EXISTING CONDITIONS: SURROUNDING CANOPY
- 24 CULTURAL AND ECOLOGICAL BACKGROUND
- 25 CULTURAL HISTORY
- 26 ECOLOGICAL HISTORY
- 27 PREFERRED CONCEPT: NORTHWEST FACING SCHEME
- 28 PREFERRED CONCEPT: PLANT PALETTE
- 29 PREFERRED CONCEPT: PERSPECTIVE RENDERING
- 30 ALTERNATE CONCEPT: CENTER FACING SCHEME
- 31 ALTERNATE CONCEPT: NORTHEAST FACING SCHEME

APPENDIX

- 33 PREFERRED CONCEPT: NORTHWEST SCHEME PLANT PALETTE
- 34 ALTERNATE SCHEME PLANT PALETTE
- 35 ALTERNATE SCHEME 2 PLANT PALETTE
- 36 REPRESENTATIVE BULB PALETTE

DAUGHTERS OF THE REPUBLIC OF TEXAS

LEGATION MEMORIAL
WASHINGTON, D. C.

SITE OVERVIEW AND CONTEXT

SITE OVERVIEW AND CONTEXT
LOCATION

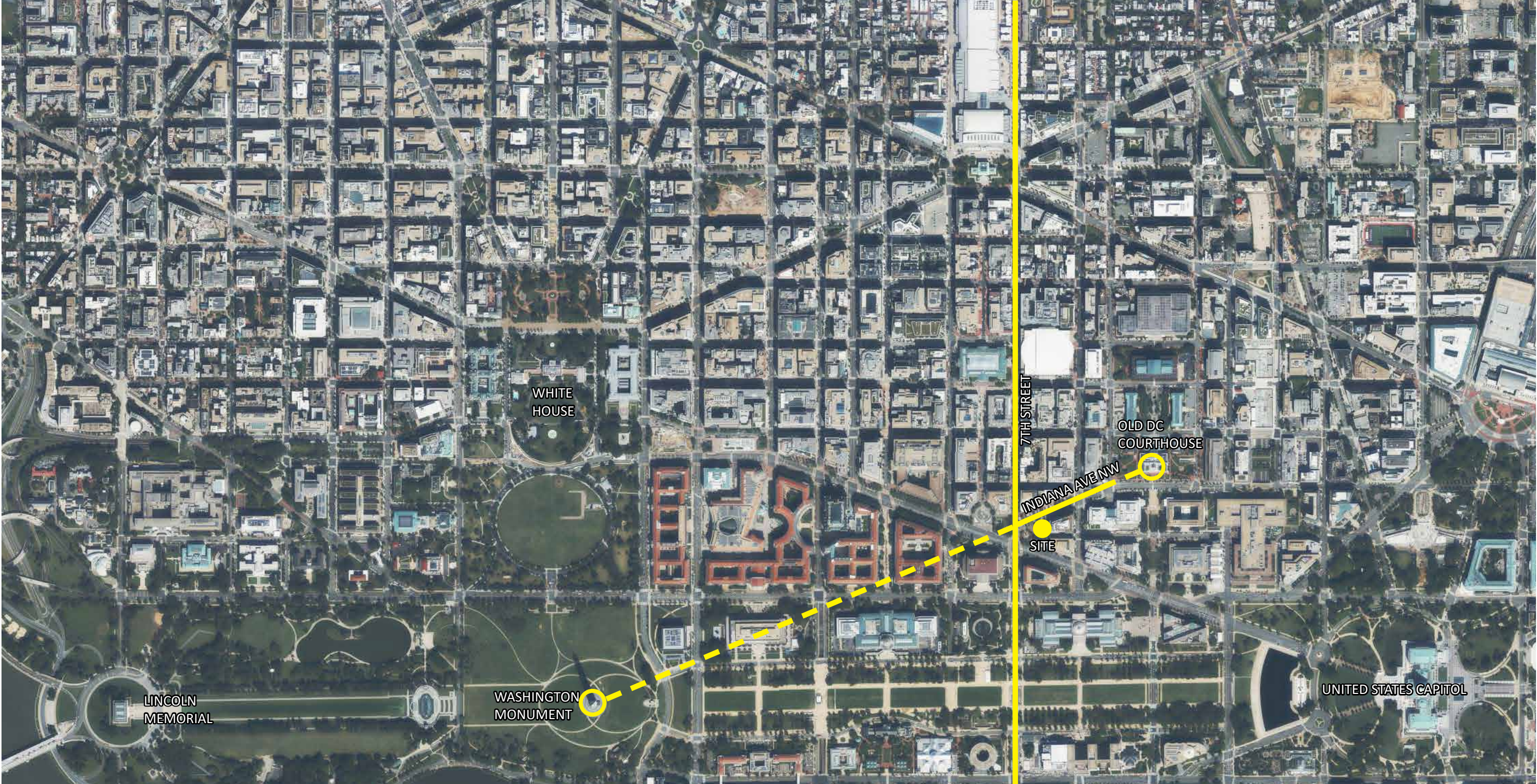

SITE OVERVIEW AND CONTEXT
LOCATION

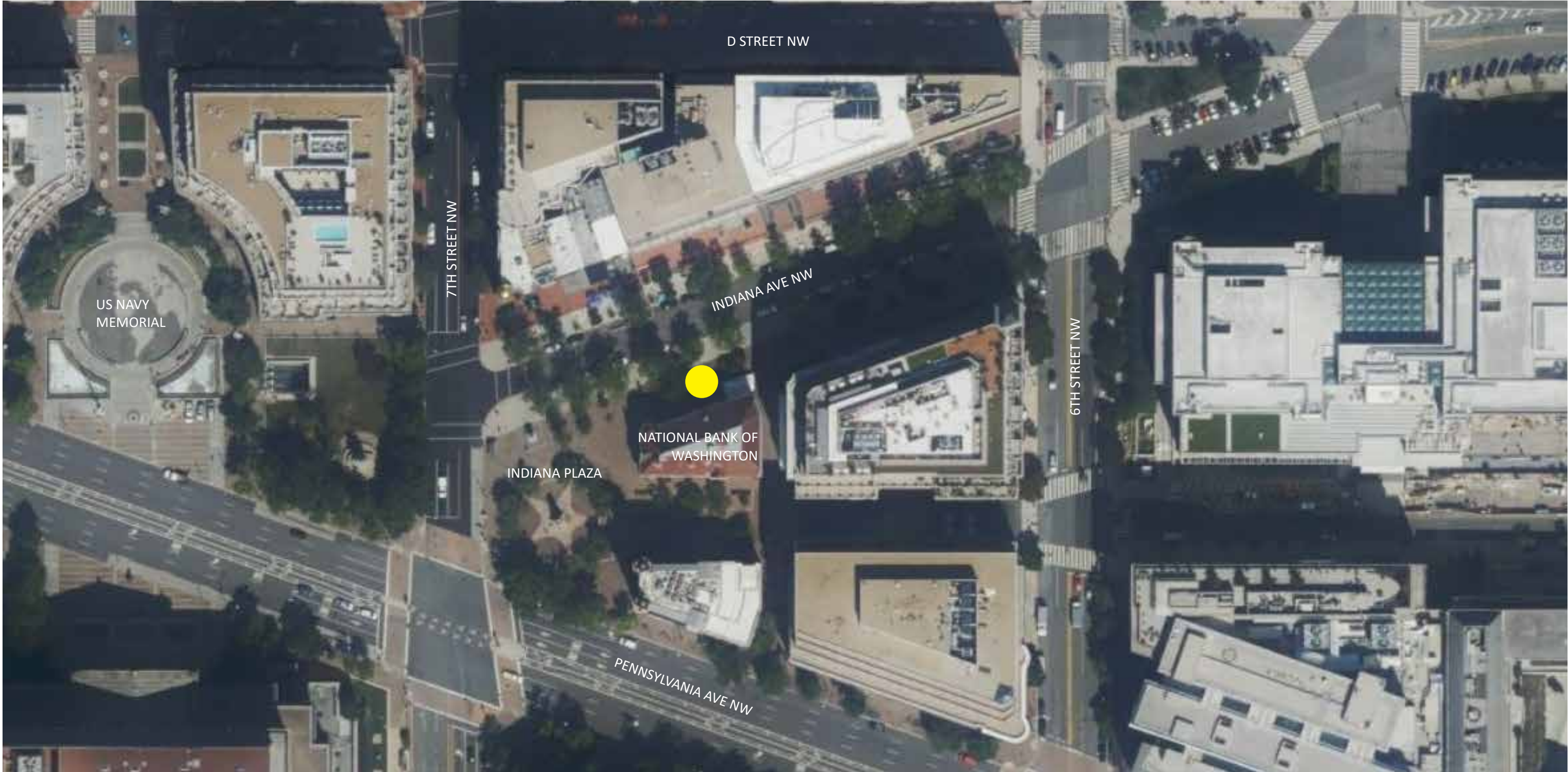

SITE OVERVIEW AND CONTEXT
SITE PHOTOS

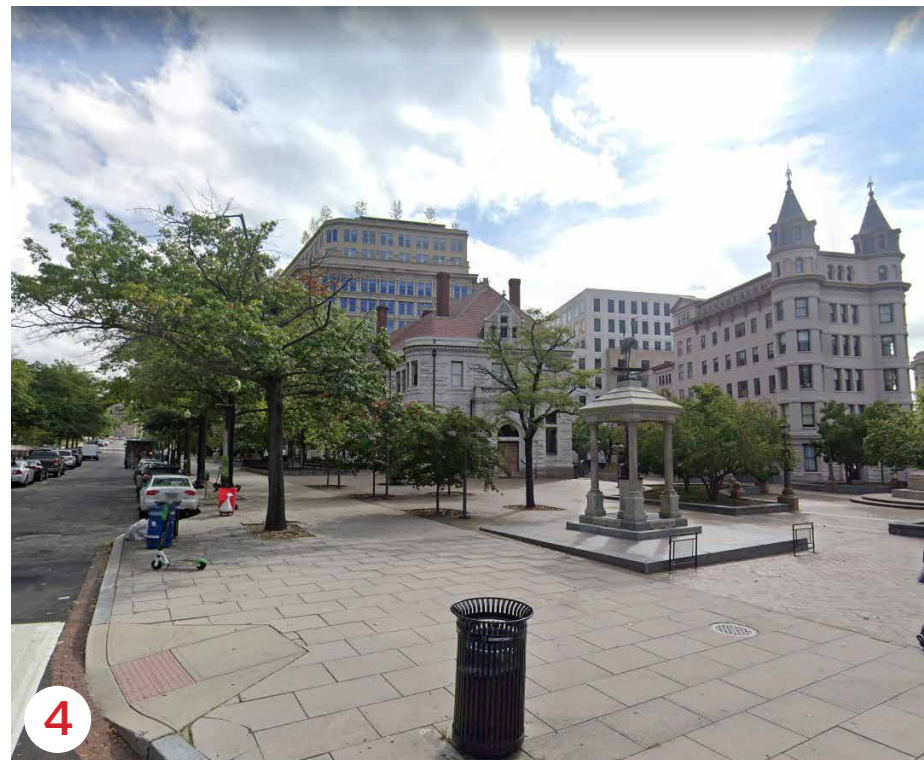
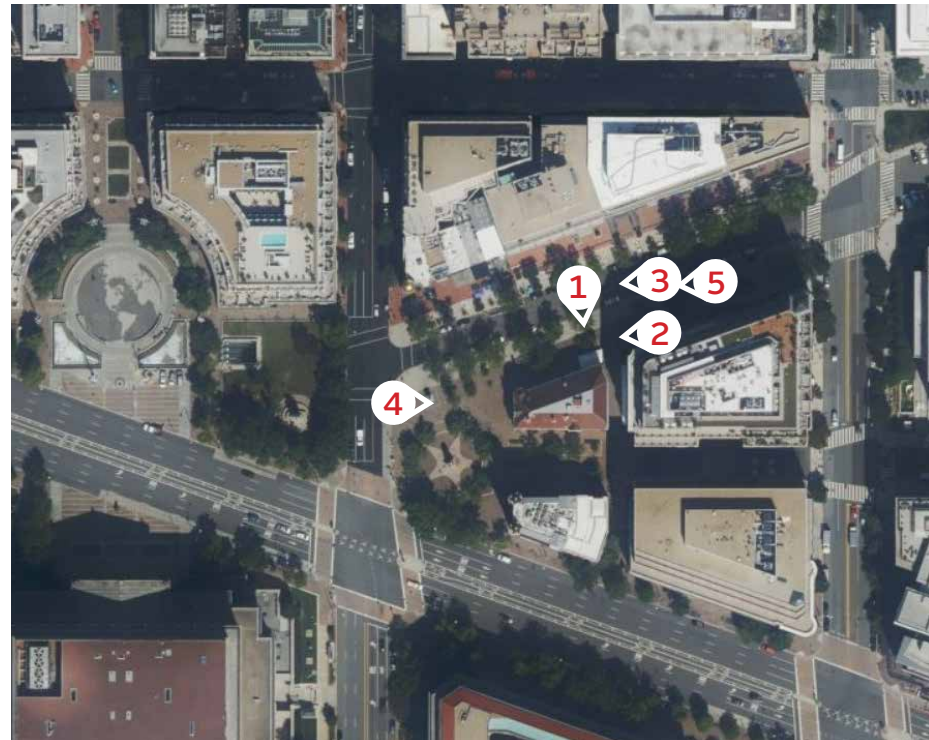

EXISTING SITE CONTEXT

MEMORIALS & SCULPTURES

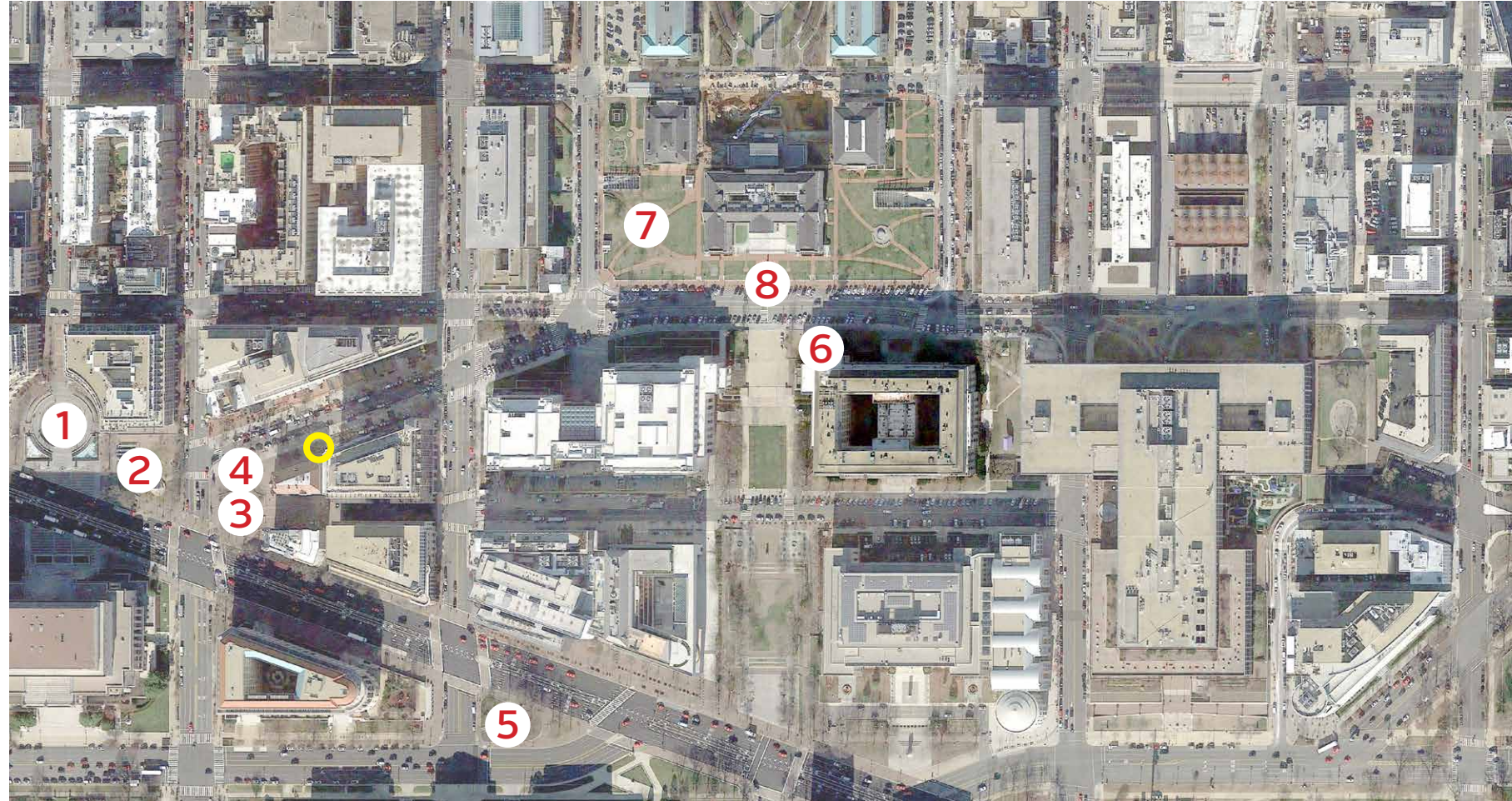

US NAVY MEMORIAL PLAZA

GENERAL WINFIELD SCOTT HANCOCK STATUE
Sculptor: Henry Ellicot

GRAND ARMY OF THE REPUBLIC MEMORIAL
Sculptor: J. Massey Rhind

TEMPERANCE FOUNTAIN

BRIGADIER GENERAL ALBERT PIKE
Artist: Gaetano Trentanove

OLD DC COURTHOUSE

DARLINGTON MEMORIAL FOUNTAIN
Artist: C. Paul Jennewein

ABRAHAM LINCOLN STATUE
Sculptor: Lot Flannery

SITE ELEMENTS
SITE CONTEXT



SITE OVERVIEW AND CONTEXT
EXISTING LANDSCAPE



BLOOMING MAGNOLIA TREES AT INDIANA PLAZA IN THE SPRING



BLOOMING MAGNOLIA TREES AT INDIANA PLAZA IN THE SPRING



MAGNOLIA TREES AT INDIANA PLAZA

DOCUMENTED HISTORICAL LOCATIONS ASSOCIATED WITH THE REPUBLIC OF TEXAS LEGATION TO THE U.S.



1	2	3	4	5	6	7	8
MEMUCAN HUNT MINISTER PLENIPOTENTIARY AND ENVOY EXTRAORDINARY	ANSON JONES MINISTER PLENIPOTENTIARY	ANSON JONES MINISTER PLENIPOTENTIARY	BERNARD E. BEE, SR. CHARGES D 'AFFAIRS	ISAAC VAN ZANDT CHARGES D 'AFFAIRS	ISAAC VAN ZANDT CHARGES D 'AFFAIRS	ISAAC VAN ZANDT CHARGES D 'AFFAIRS	C.H. RAYMOND ACTING CHARGES D 'AFFAIRS
Mrs. Page's boardinghouse Today it is the Navy Memorial	Mrs. Pittman's boardinghouse Today it is the William B. Bryant Annex to the US Courthouse	Gadsby's Hotel Today it is the John's Hopkins Campus	M. Lawrence's, near Gadsby's Today it is the Canadian Embassy	Mrs. Bowen's boardinghouse Today it is the Patrick Henry Building	Boardinghouse Today it is a commercial office building	F street between 13th and 14th streets Today it is a commercial office building on F street	Mr. Underwood's Today it is the Cannon House Office Building
1837-1838	1839	1839	1840-1842	1843	1843-1844	1844	1845

SITE OVERVIEW AND CONTEXT

SITE PLAN



SITE OVERVIEW AND CONTEXT
EXISTING CONDITIONS



REMOVE EXISTING
TREES (3)

REMOVE EXISTING
LIGHT POLES

DAUGHTERS OF THE REPUBLIC OF TEXAS

LEGATION MEMORIAL
WASHINGTON, D. C.

DESIGN

EXISTING CONDITIONS



EXISTING CONDITIONS

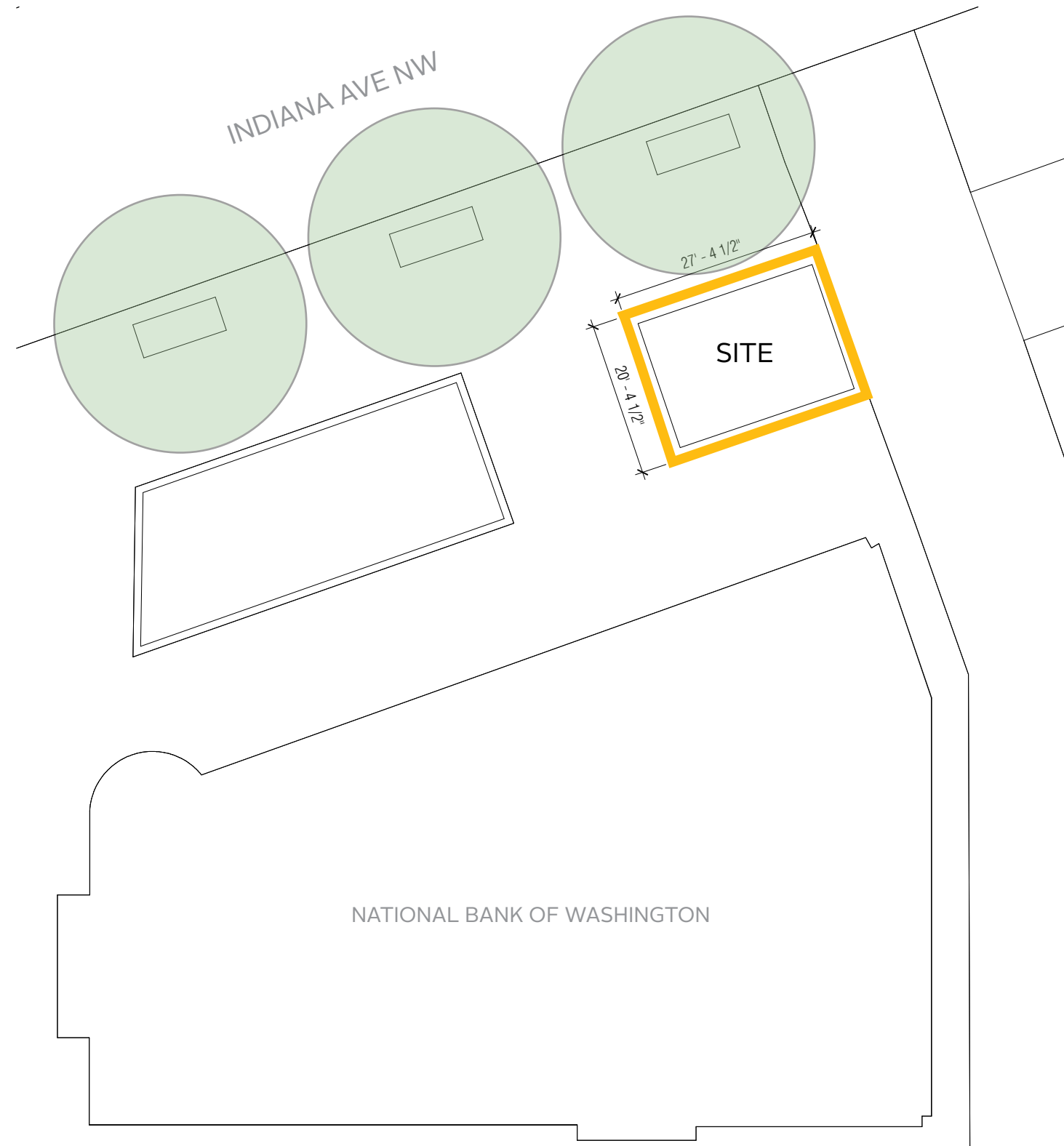

DESIGN CONCEPT

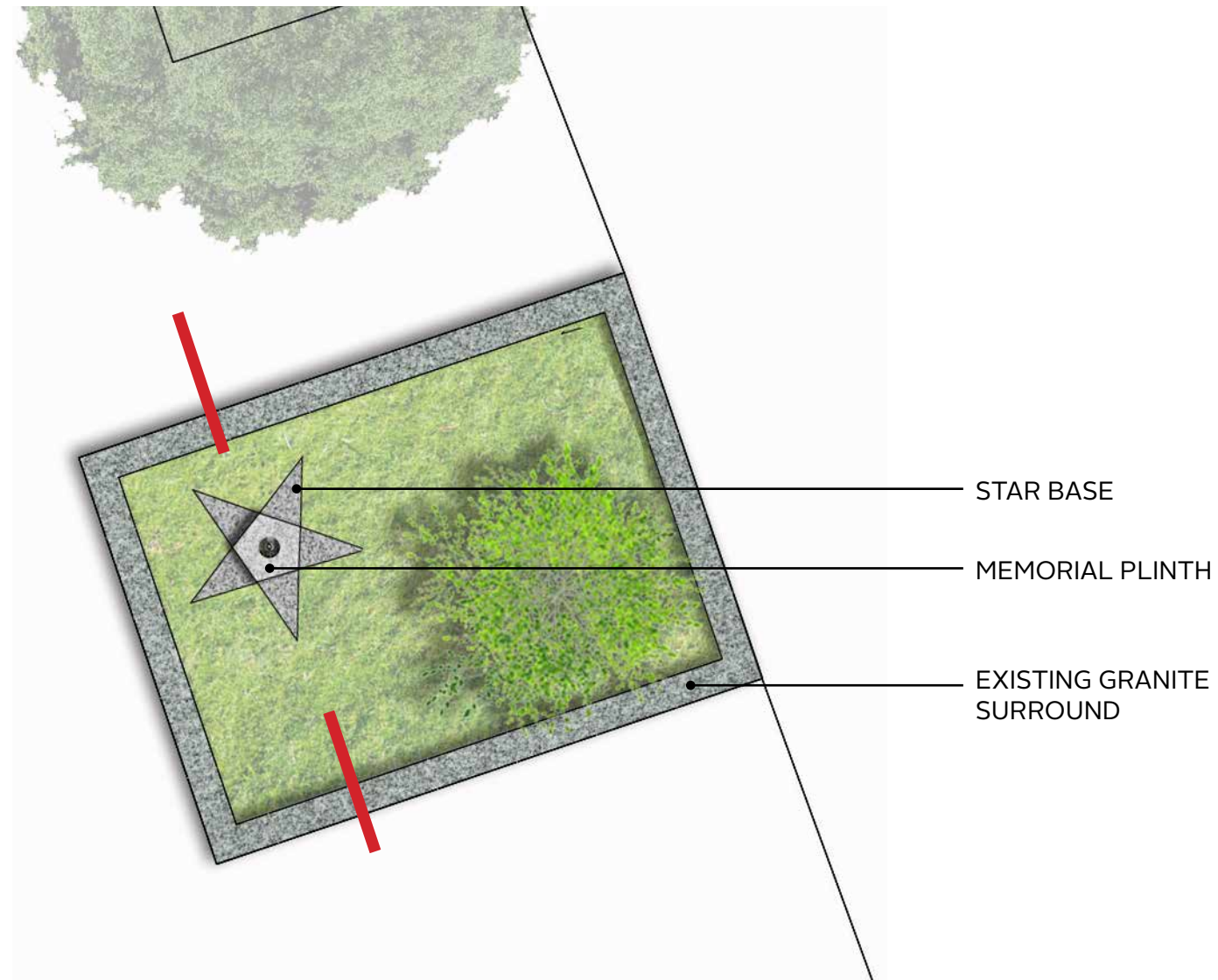

DESIGN CONCEPT ELEVATION

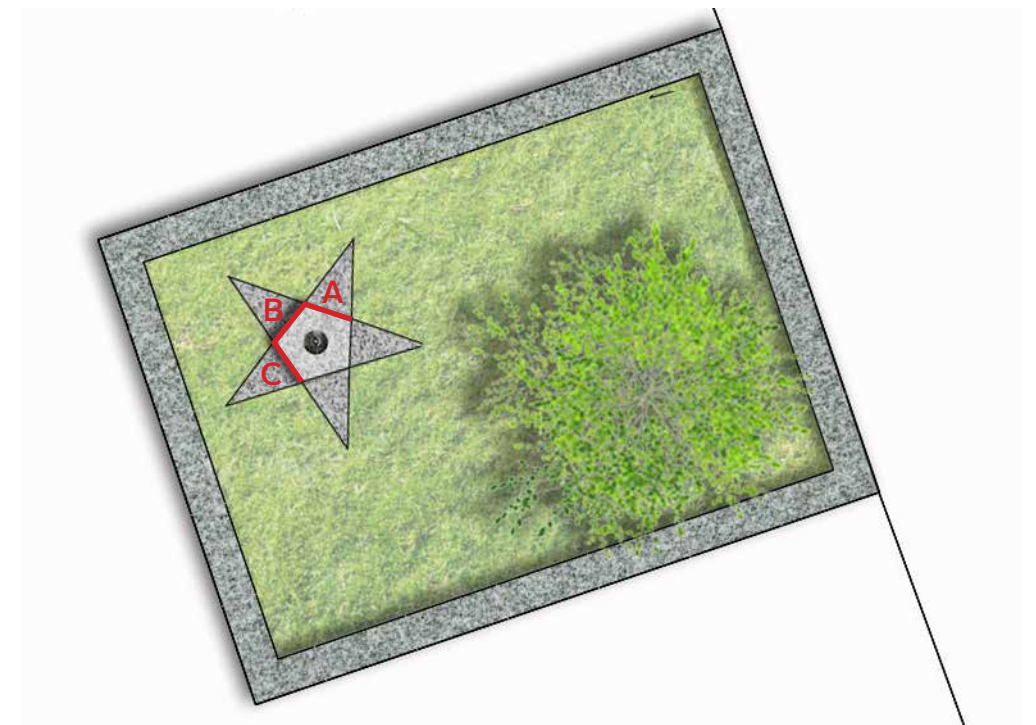
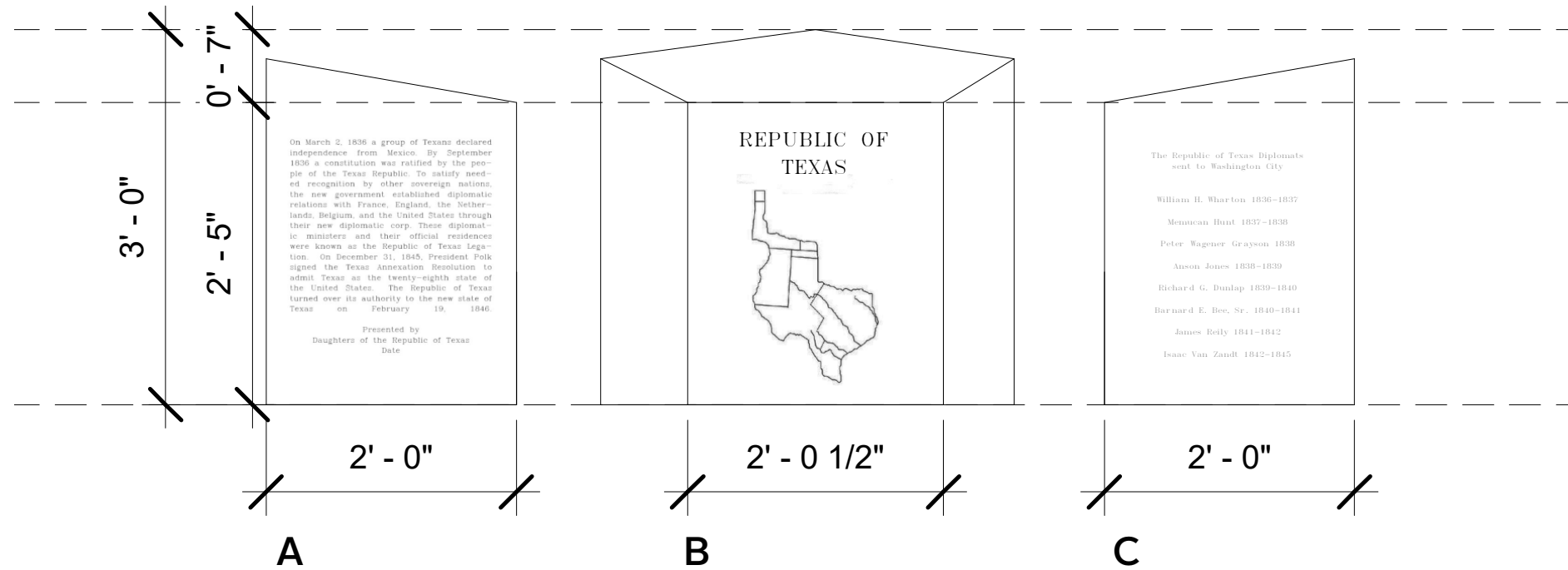
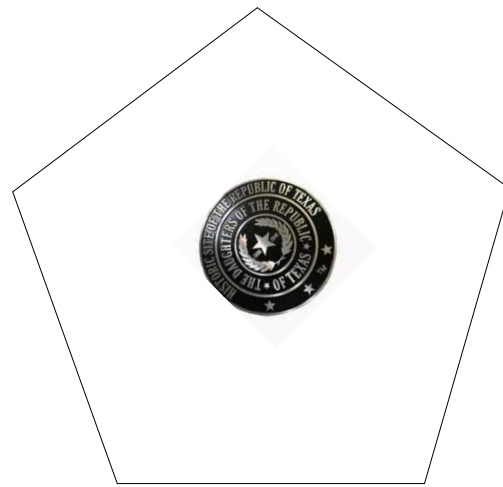

DESIGN CONCEPT SECTION

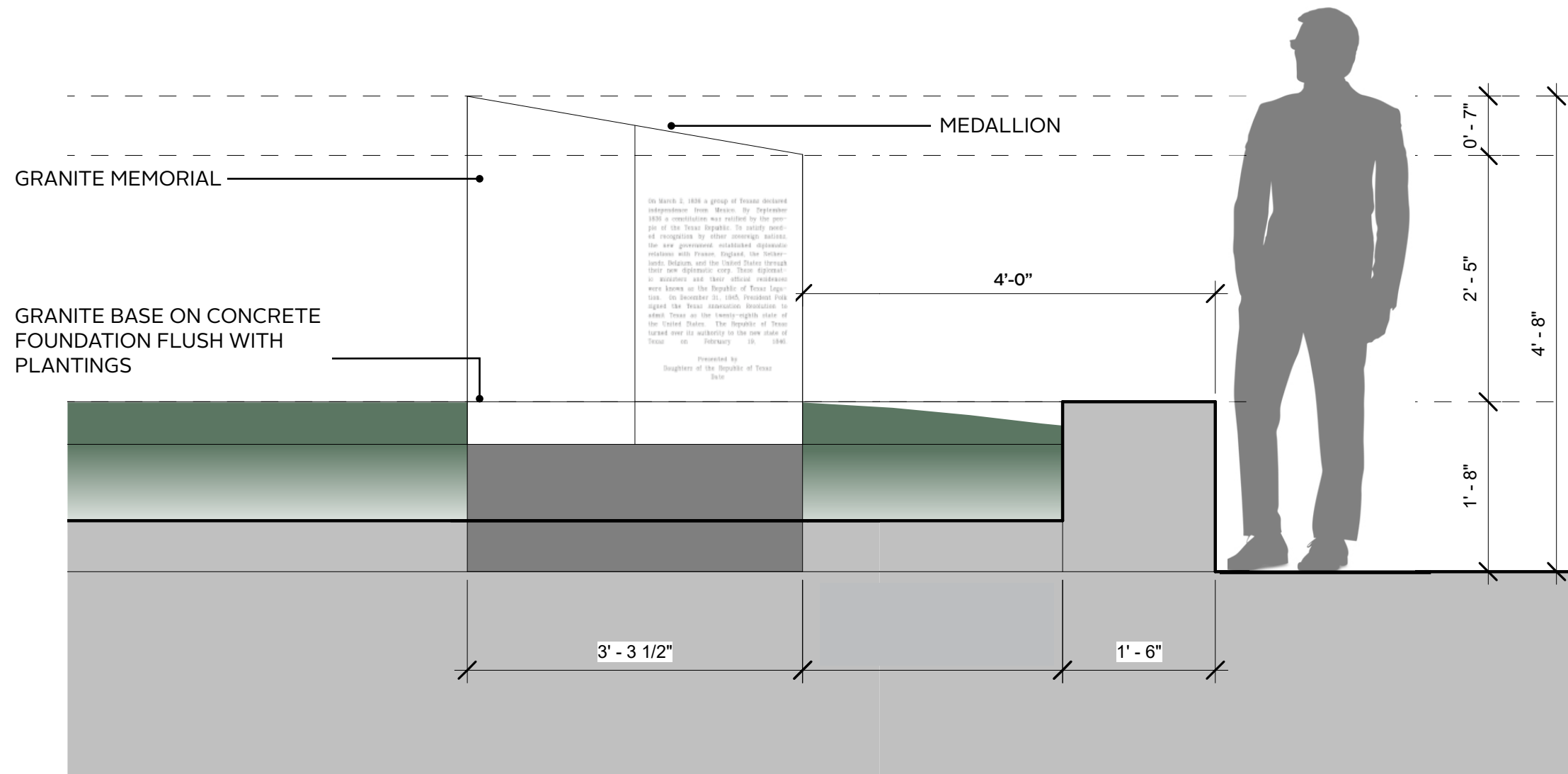

MEDALLION SHOWN HERE IS AT THE SAME SCALE AS THE SECTION

DESIGN CONCEPT
MATERIALS

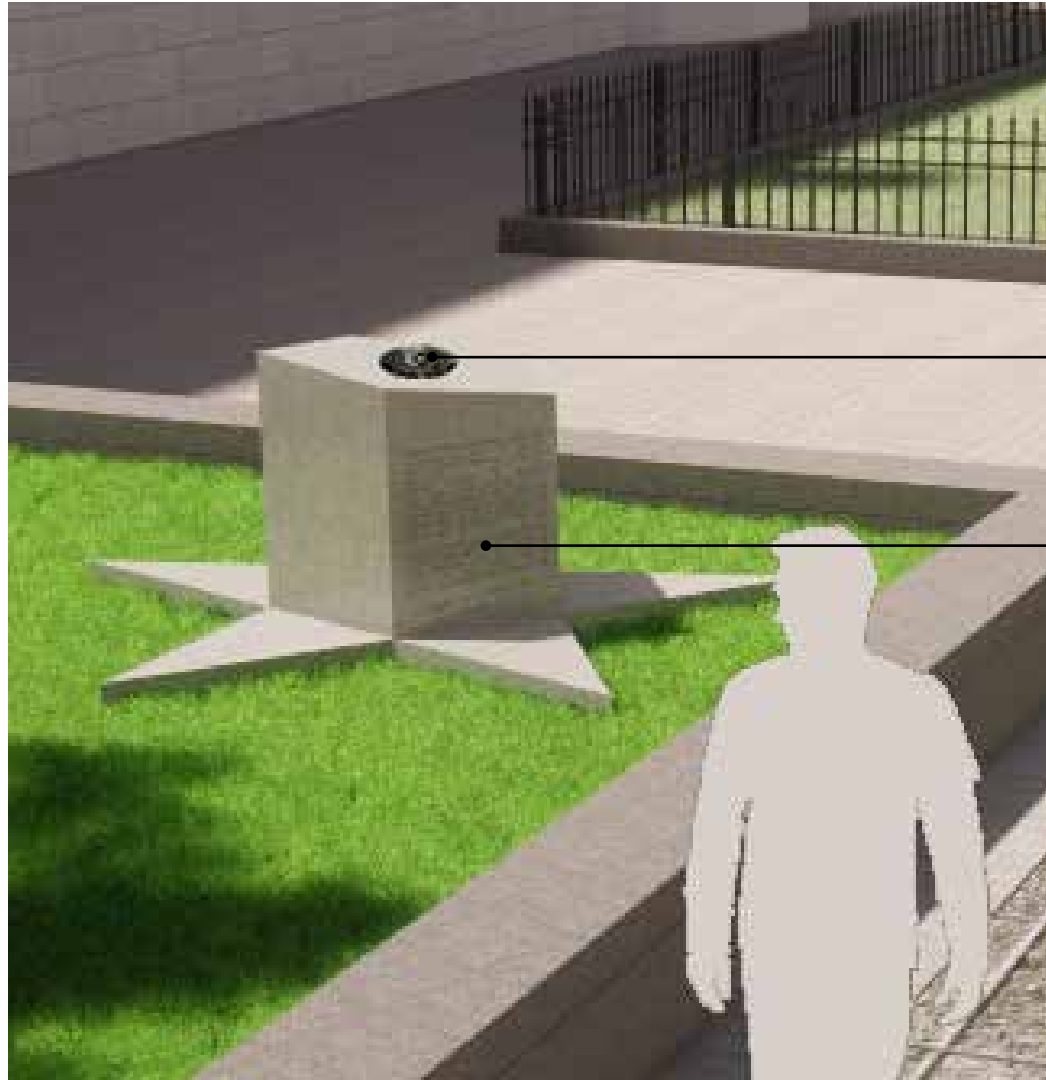

11" DRT HISTORIC SITES MEDALLION
(PROVIDED BY THE DRT)



MEMORIAL PLINTH AND STAR BASE
WHITE MT. AIRY GRANITE

DESIGN CONCEPT

MEMORIAL ENGRAVING DETAILS

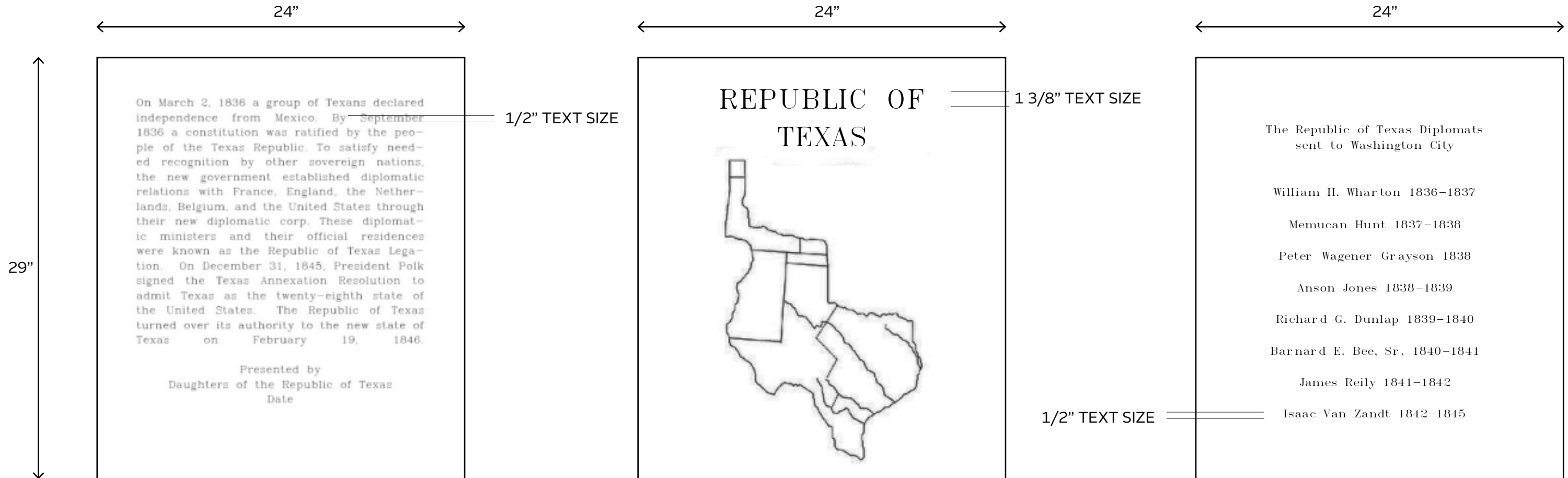

DAUGHTERS OF THE REPUBLIC OF TEXAS

LEGATION MEMORIAL
WASHINGTON, D. C.

LANDSCAPE DESIGN

EXISTING CONDITIONS: SOLAR STUDIES

10:00 AM

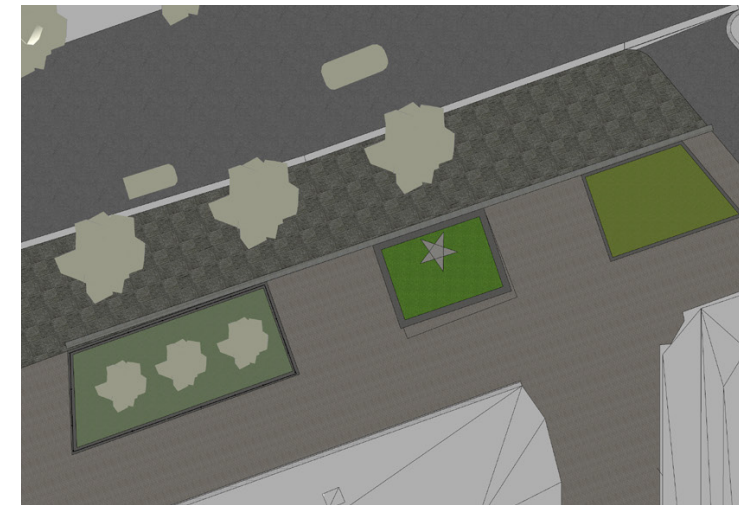
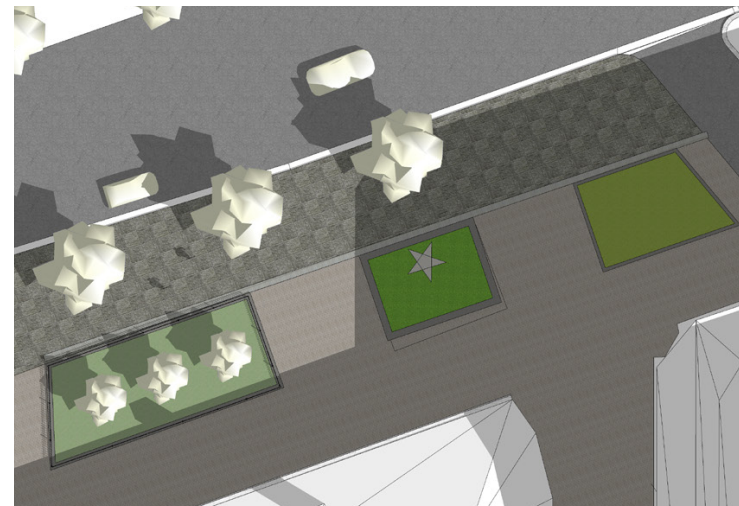
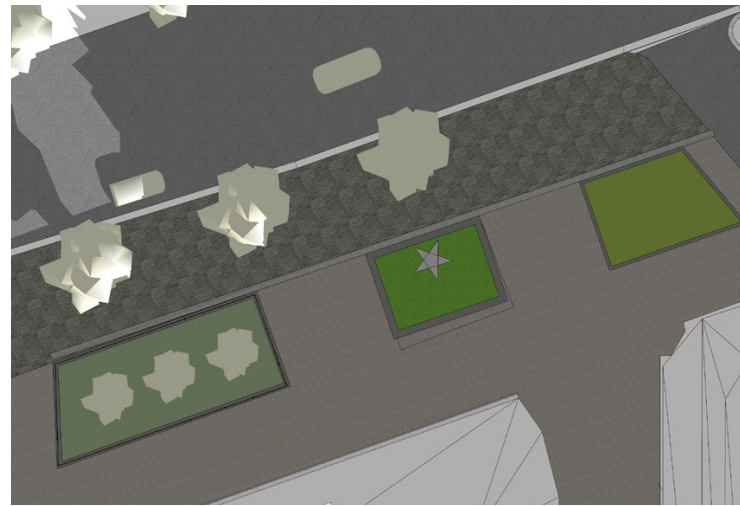

NOON

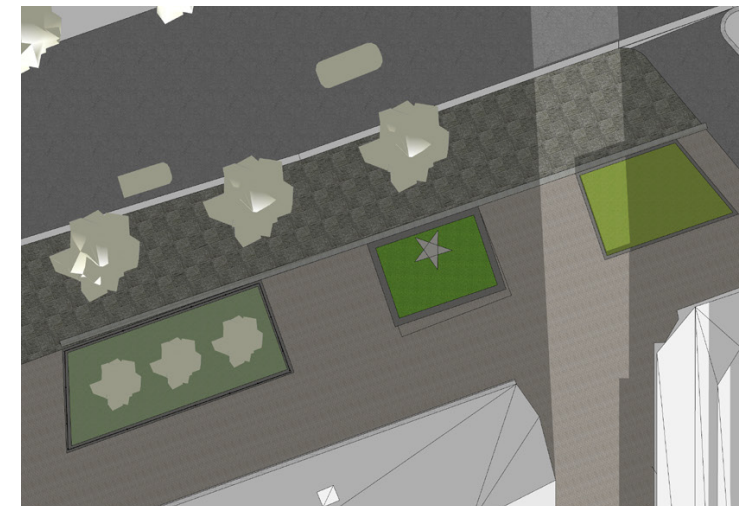
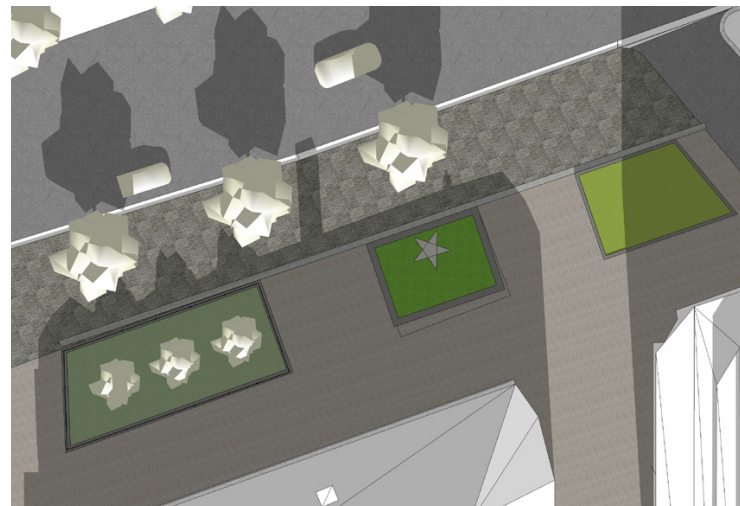

03:00 PM

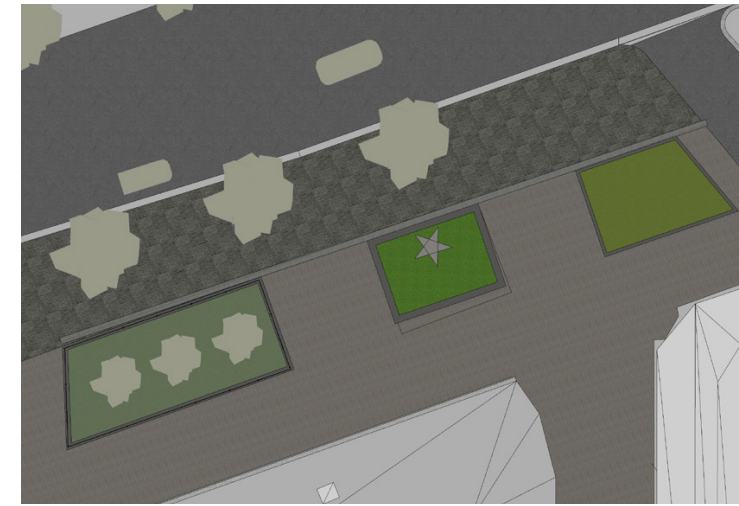
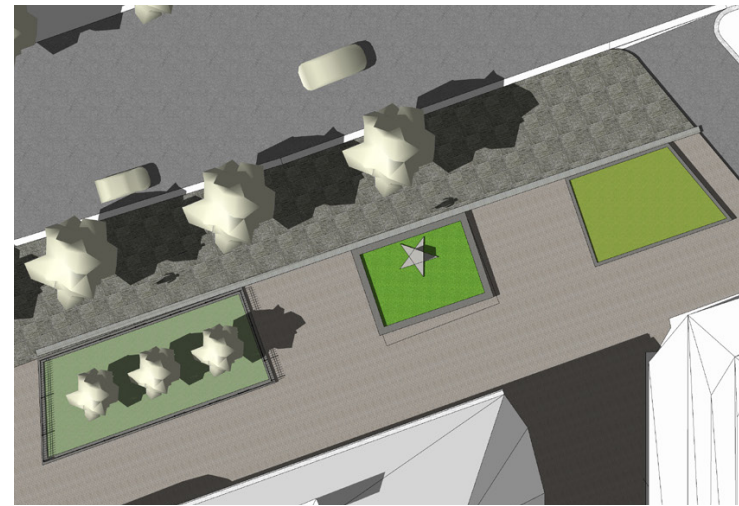
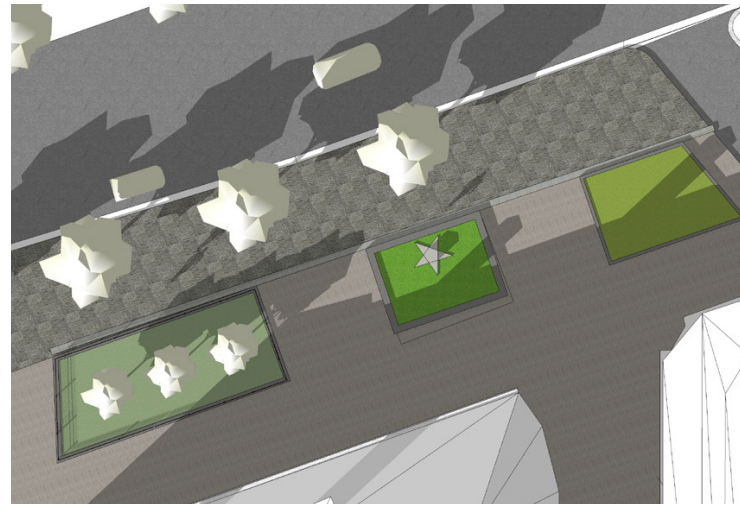

SPRING EQUINOX

SUMMER SOLSTICE

WINTER SOLSTICE

EXISTING CONDITIONS: SURROUNDING CANOPY

LEGEND:

-  *Koelreuteria paniculata*
Golden Rain Tree
-  *Lagerstroemia* sp.
Crape Myrtle
-  *Quercus bicolor*
Swamp White Oak
-  *Quercus lyrata*
Overcup Oak
-  *Quercus palustris*
Pin Oak
-  *Quercus imbricaria*
Shingle Oak
-  *Quercus texana*
Nuttall Oak
-  *Quercus rubra*
Red Oak
-  *Gleditsia triacanthos*
Honey Locust
-  *Magnolia x soulangeana*
Saucer Magnolia



LANDSCAPE DESIGN

CONCEPT DEVELOPMENT: CULTURAL + ECOLOGICAL BACKGROUND



CONCEPT DEVELOPMENT: CULTURAL HISTORY

1821



1836



1845



Pre-Republic

By 1821, Texas was part of Mexico after Mexico had gained independence from Spain. Tensions between Mexico and the United States began to intensify in the following decade.

Republic

Texas became an independent republic in 1836, and remained so for almost 10 years. The Lone Star flag was adopted in 1839.

Joining the Union

As part of the Texas Annexation Act in 1845, Texas was admitted as the 28th State of the United States of America. The formal transfer of power took place in February 1846.

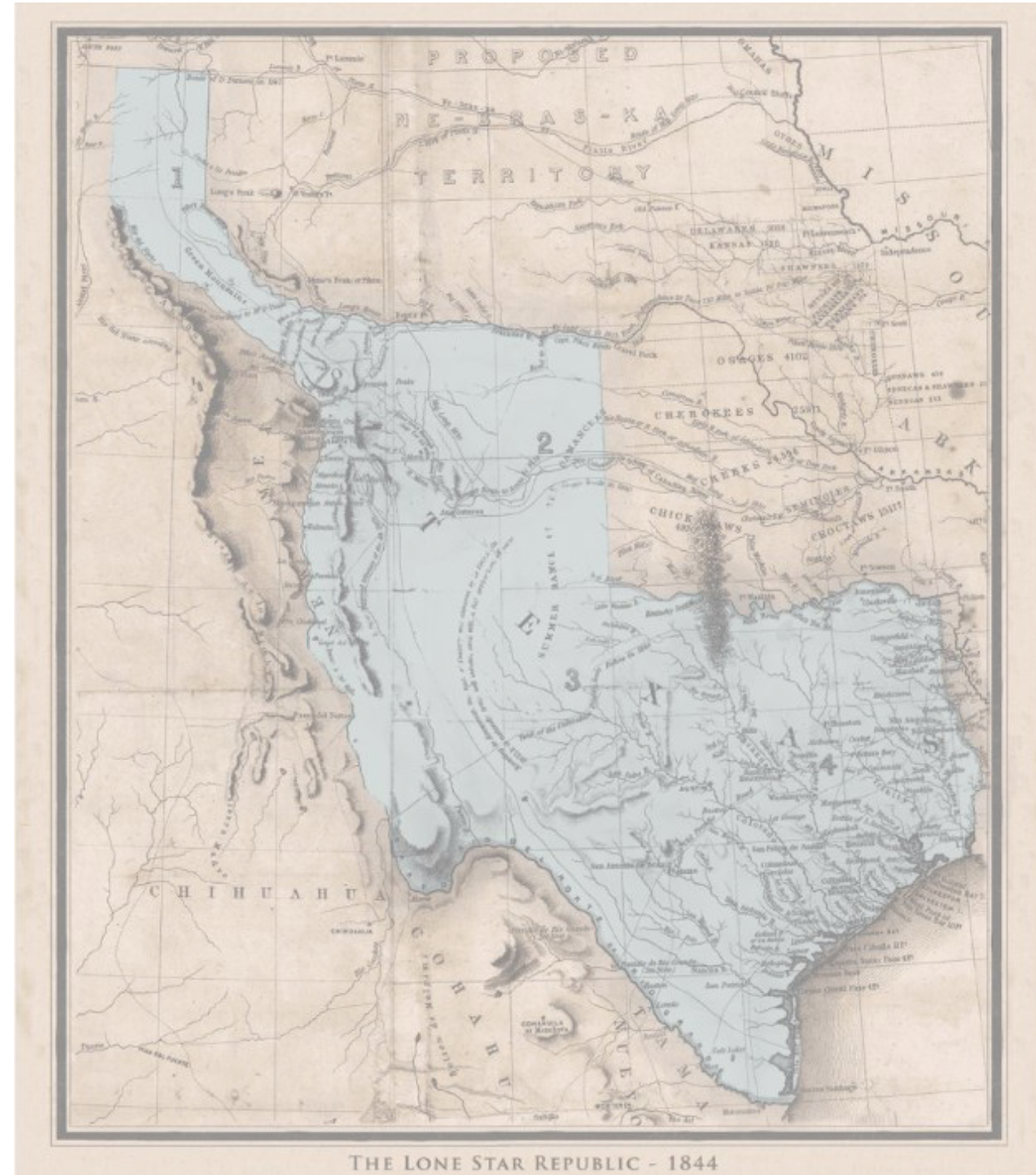

William H. Emory and William James Stone. *Map of Texas and the countries adjacent* (detail, boundaries highlighted). Washington, D.C., War Department, 1844

CONCEPT DEVELOPMENT: ECOLOGICAL REGIONS

Ecoregions

Texas covers 266,807 square miles of land, incorporating areas of huge diversity in climate, landscape and wildlife.

Given size and geographical location, **Texas is located at a unique crossroads of regional habitats**, where eastern continental habitats meet western ones and where northern habitats meet southern ones.

West Texas typically ranges from **semi-arid to arid desert**.

East Texas is typically defined by the “Piney woods” region with **rich bottomlands**.

Washington-On-The-Brazos

The **Brazos River basin** divides East from West Texas, spanning 45,000 square miles through the center of the state.

Toward the mouth of the river, Washington, Texas is situated along the Brazos. It was in this town, 60 years after the United States signed its Declaration of Independence in Philadelphia, where **Texas signed its Declaration of Independence from Mexico in March, 1836**.

After the Civil War, the unincorporated community became known as “*Washington-on-the-Brazos*” to distinguish the integral settlement from “*Washington-on-the-Potomac*,” Washington, D.C.

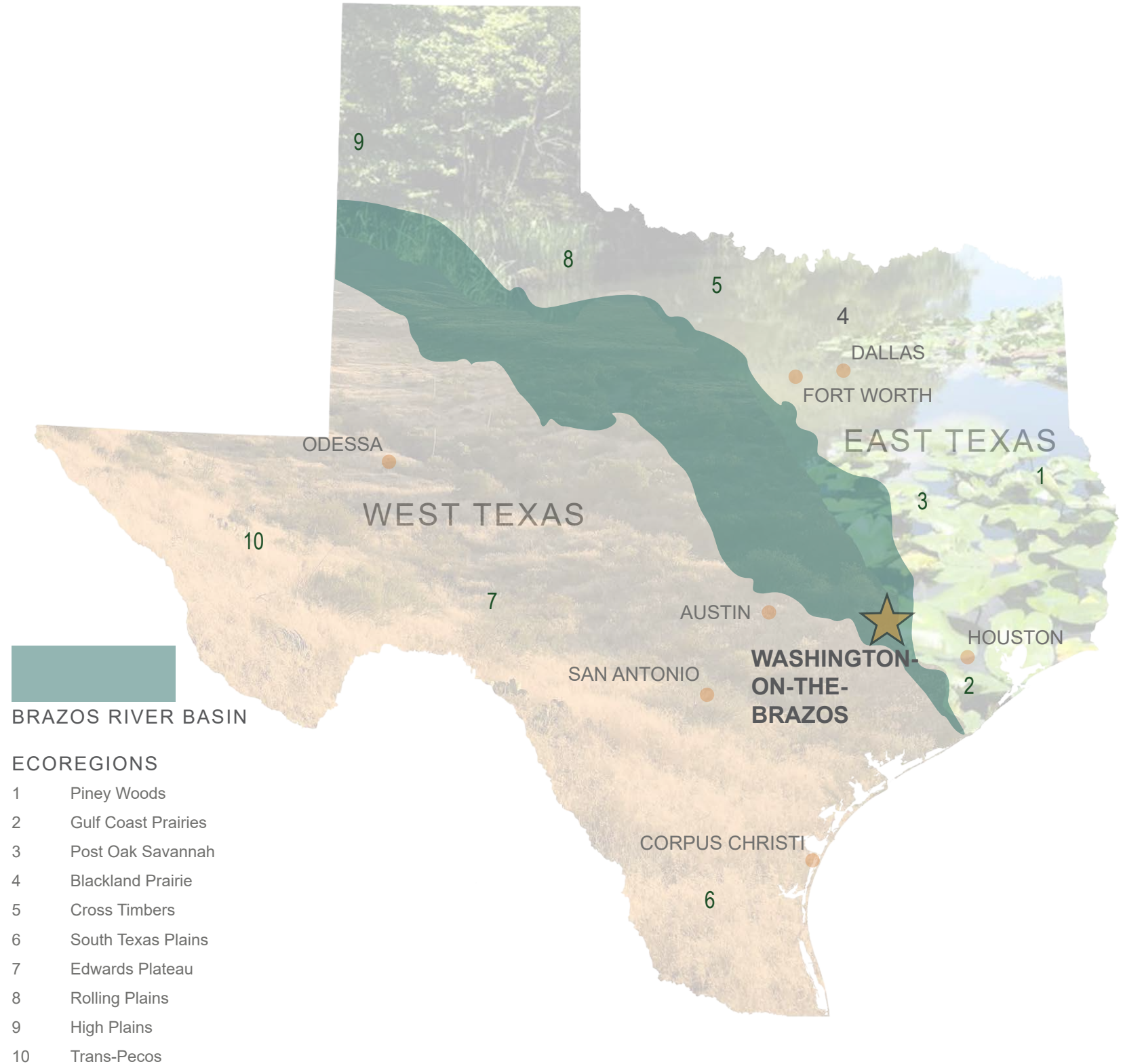

LANDSCAPE DESIGN
DESIGN CONCEPTS

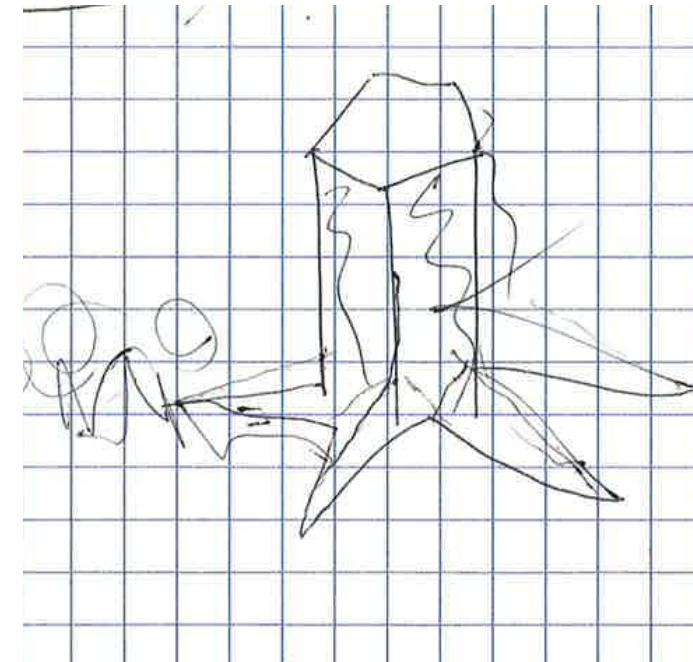
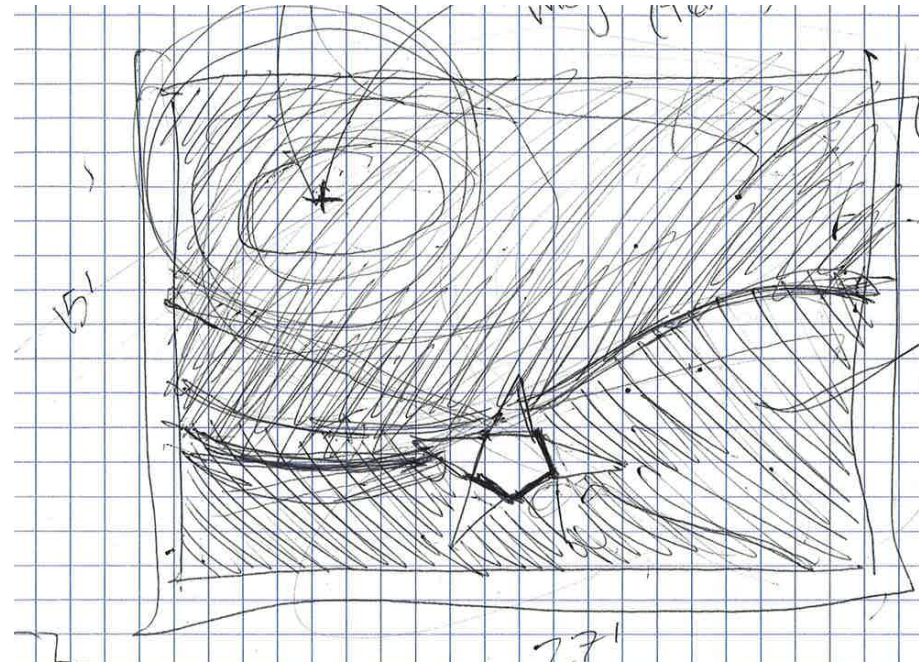
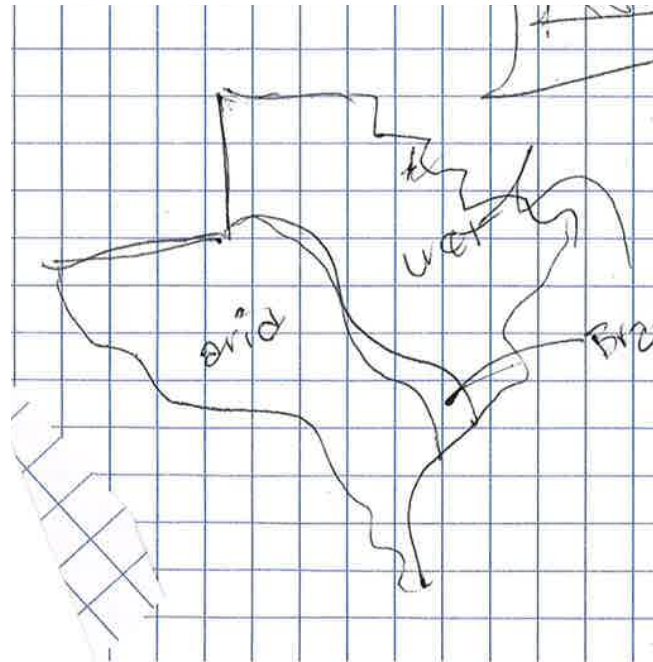

DESIGN CONCEPT: PLAN AND PLANTING SELECTION

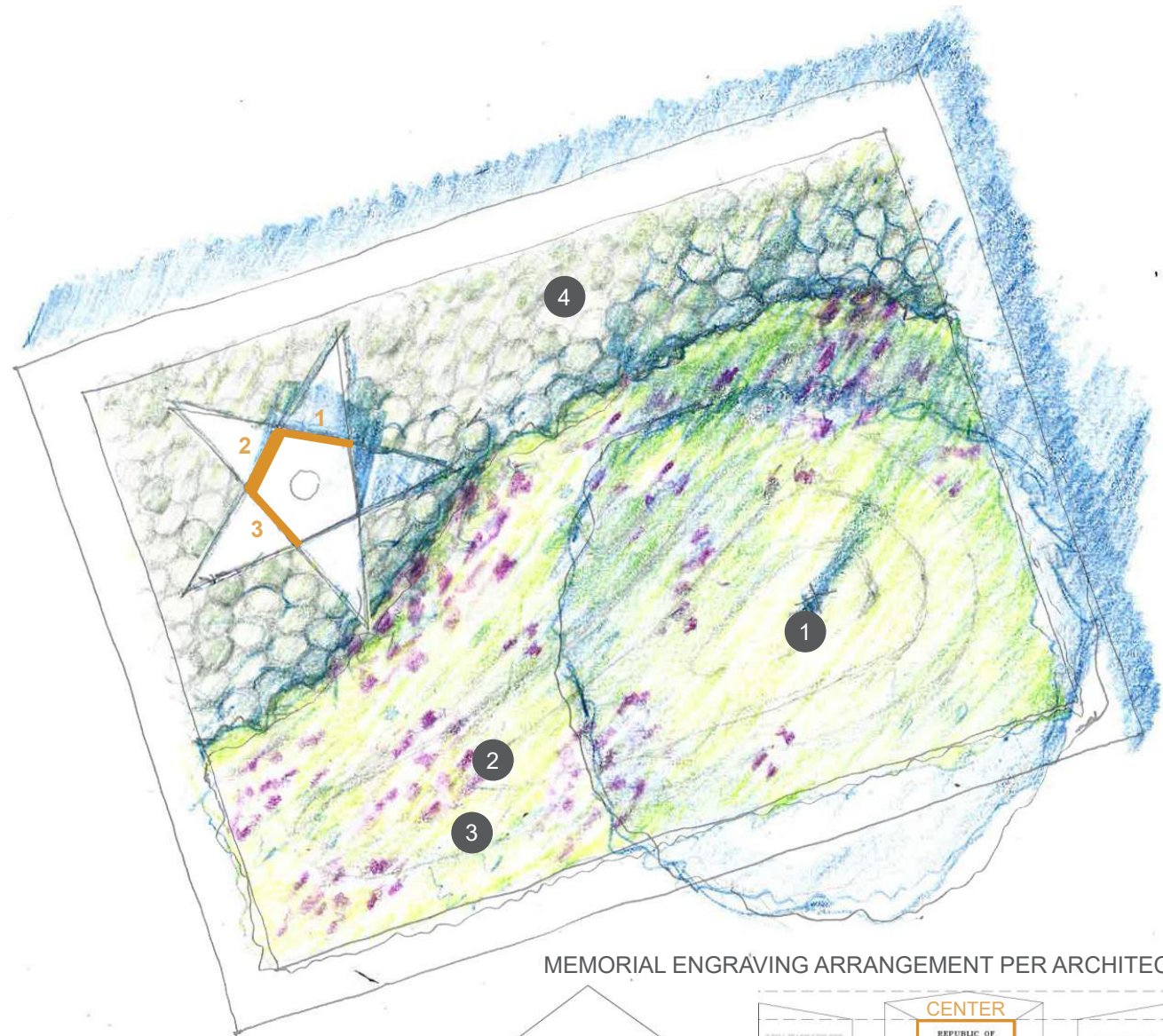

MEMORIAL ENGRAVING ARRANGEMENT PER ARCHITECT

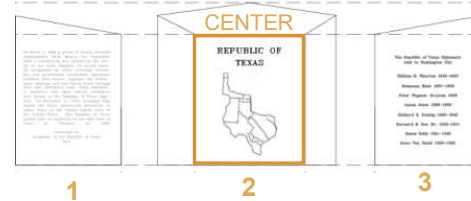
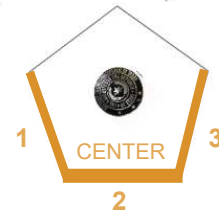

The memorial planter is organized by two asymmetrical plant palettes, oriented to the NW corner where the memorial signage is located. A field of low-growing, native evergreen sedge makes up the foreground, maintaining visual access to the plinth. Beyond, an interplanted field of native meadow plants, Blue Grama grass and Blazing star, create a taller backdrop. The organic shape relates to the Brazos River Basin that defines the two distinct landscapes of Texas.

Soil bermed at the rear (southeast) corner of the planter creates a subtle high point where a Sweetbay Magnolia tree is located on a visual axis from the memorial plinth. The solitary tree with its singular, pronounced white blossoms represents the lone star state and Texas's time period as a republic. The two juxtaposed native planting zones recall the diversity, orientation, and unique breadth of Texas's ecological regions across the state. The selection of plants that comprise the memorial are both native to Texas and native to the mid-Atlantic milieu of Washington, DC.



1 ALTERNATIVE A: *MAGNOLIA VIRGINIANA*
Sweetbay Magnolia - TREE & FLOWER



2 *BOUTELOUA GRACILIS* 'BLONDE AMBITION'
Blue Grama Grass



3 *LIATRIS SPICATA* 'KOBOLD'
Blazing Star



1 ALTERNATIVE B: *CERCIS CANADENSIS* or
TEXENSIS / Redbud (Eastern or Texan) - FLOWER
& LEAF



4 *CAREX LAXICULMIS* 'HOBB'
Bunny Blue Sedge



BULB PLANTING CHARACTER IMAGE
Provides early-mid Spring seasonal interest.

*See Appendix 1 for information on plant material and Appendix 4 for bulb alternatives.

DESIGN CONCEPT: PLANT PALETTE



Magnolia virginiana
(Sweetbay Magnolia)
ALT A

Semi-Evergreen Understory Tree

Height 15 - 30 ft.
Width 8 - 12 ft.

Native Status: Native on the US East Coast Coastal Plain. Native in East Texas.

Flower: Single saucer-like white lemon-scented flowers in late spring and early summer.

Description: Small, multistemmed compact upright habit. Lustrous dark green leaves with silver tones beneath. A graceful specimen tree that works well in a smaller area and requires minimal maintenance.



Cercis canadensis var. canadensis (or texensis)
(Redbud) ALT B

Deciduous Understory Tree

Height 15 - 20 ft.
Width 10 - 15 ft.

Native Status: *C. canadensis* is native from New Jersey in the north to Texas in the south. *C. texensis* is native in central Texas, Oklahoma and Mexico.

Flower: Pink/purple flowers in the early spring. The flowers cover the entire tree, including the trunk and branches.

Description: Multistem or single stem small tree with thick, leathery leaves. Works well as a single tree or in a grouping.



Bouteloua gracilis 'Blonde Ambition'
(Blue Grama Grass)

Deciduous Ornamental Grass

Height 0.75 - 2.5 ft.
Width 0.75 - 1.5 ft.

Native Status: A dominant shortgrass prairie species, native in north and west Texas.

Flower: Horizontal chartreuse inflorescences in early to mid-summer, persisting into winter when they become blonde/brown.

Description: Drought tolerant grass with blue/gray blades that grows in prairies, plains and open woodlands. Feathery grass tips catch the sunlight and provide drama when planted in mass. Grass turns straw-colored in Fall.



Liatris spicata 'Kobold'
(Blazing Star)

Deciduous Perennial

Height 1.5 - 2.5 ft.
Width 0.5 - 1 ft.

Native Status: Native to the eastern United States as far west as Louisiana. Though not native in Texas, it is in the same genus as the native *Liatris punctata* (dotted blazing star).

Flower: Light purple flowers bloom in late summer through to September.

Description: Drought tolerant and pollinator friendly. The prominent, dramatic flower spikes provide nectar for wildlife, while the later seedheads provide food for birds.



Carex laxiculmis 'Hobb'
(Bunny Blue Sedge)

Evergreen Sedge

Height 8 - 12 in.
Width 12 - 16 in.

Native Status: Native to the eastern United States.

Flower: Insignificant creamy white flowers appear in May - June.

Description: A small compact grass that will slowly spread over time. The silvery-blue leaves are predominantly evergreen, but benefit from a cutback in late winter.

LANDSCAPE DESIGN

DESIGN CONCEPT: PERSPECTIVE RENDERING



DESIGN CONCEPT: ALTERNATE SCHEME 1

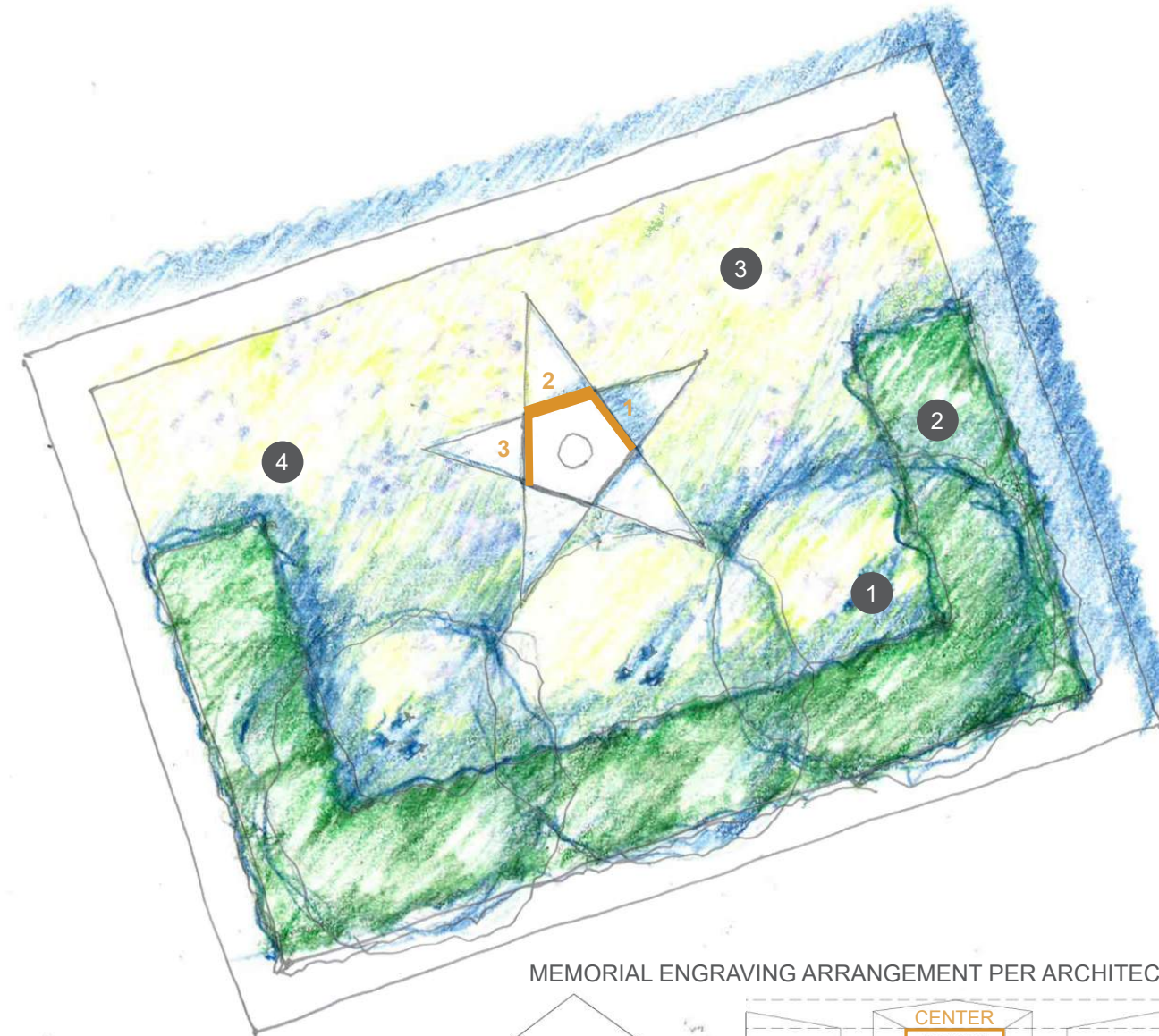

MEMORIAL ENGRAVING ARRANGEMENT PER ARCHITECT

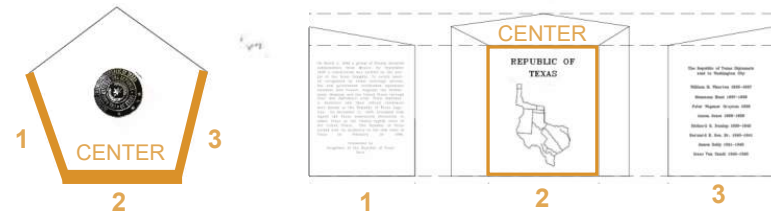

Foreground: Low-growing mixture of native Eastern Blue star and non-native Autumn Moor grass evokes the unique mixture of influences in Texas stemming from periods of European colonization.

Hedge: Dwarf Yaupon Holly, native to both Texas and the mid-Atlantic, evokes protection and surrounds the rear of the planter, providing an evergreen backdrop for the memorial plinth.

Rear/Small Trees: Three witch hazels represent the three time periods of significance related to the Legation of Texas



1 *HAMAMELIS VIRGINIANA*
Witch Hazel

*See Appendix 2 for information on plant material



2 *ILEX VOMITORIA 'SCHILLINGS'*
Yaupon Holly



3 *SESLERIA AUTUMNALIS*
Autumn Moor Grass



4 *AMSONIA 'BLUE ICE'*
Eastern Bluestar

DESIGN CONCEPT: ALTERNATE SCHEME 2

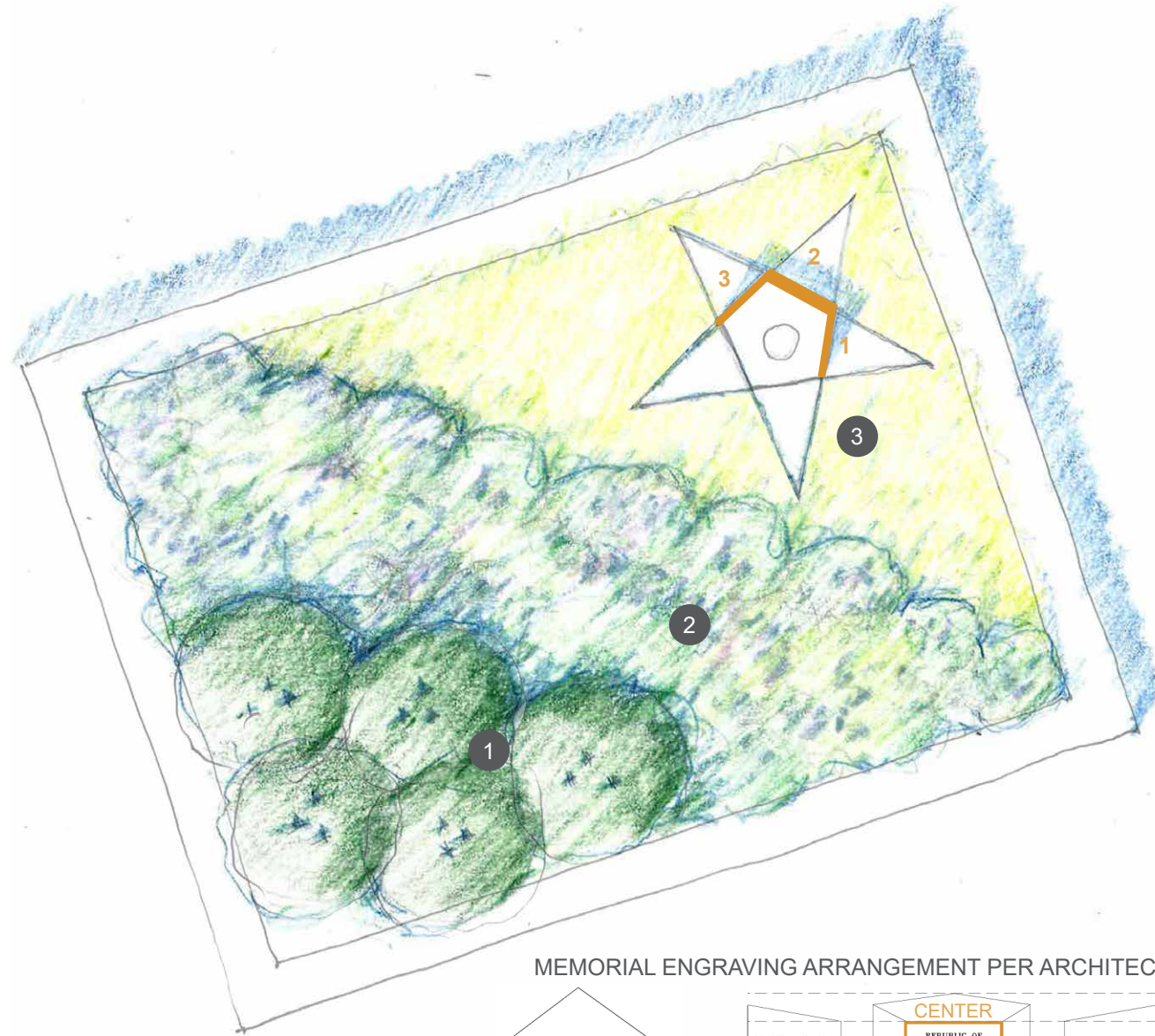

MEMORIAL ENGRAVING ARRANGEMENT PER ARCHITECT

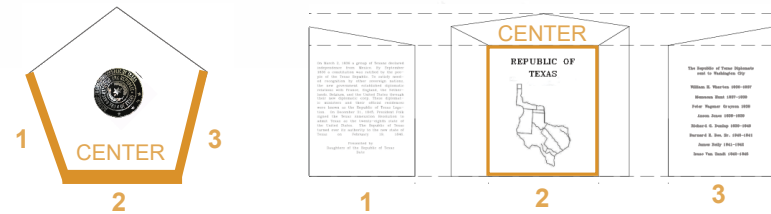

Foreground: Low-growing Mexican Feather Grass evokes the arid climate of Texas's SW ecological region.

Transitional Zone: A zone of native Hubricht's Blue Star provides a mid-height planting layer and cuts across the planter diagonally like the Brazos River Basin, which divides arid and wet regions of the state.

Rear/Small Shrubs: A mass of Winterberry shrubs provides the final backdrop layer for the memorial and recalls the wetter climate of the NE portion of the state. Red berries provide winter interest.



1 ALTERNATIVE A: *VIBURNUM DENTATUM* 'BLUE MUFFIN' / Arrowwood Viburnum



1 ALTERNATIVE B: *ILEX VERTICILLATA* 'NANA' / Red Sprite Winterberry



2 *AMSONIA HUBRICHTII* Threadleaf Bluestar

*See Appendix 3 for information on plant material



3 *NASSELLA TENUISSIMA* Mexican Feather Grass

LANDSCAPE DESIGN
APPENDIX

DESIGN CONCEPT: ALTERNATE SCHEME 1 PLANT PALETTE



Hamamelis virginiana or vernalis
(Witch Hazel)

Deciduous shrub / small tree

Height 15 - 20 ft. (virginiana); 6 - 10 ft. (vernalis)
Width 15 - 20 ft. (virginiana); 8 - 15 ft. (vernalis)
Sun Sun / Part Shade
Water Medium

Native Status: Native in eastern America, from Nova Scotia south to Florida and eastern Texas.

Flower: Yellow, sometimes tinged with orange or red, blooms appear after all the leaves have dropped. *H. virginiana* blooms sometime in late Fall to early winter; *H. vernalis* blooms sometime in mid-winter to early Spring.

Description: Handsome architectural habit that can be a large shrub or small tree. Green leaves turn yellow in autumn. The plant is tolerant of city conditions and can be easily pruned if it grows too large.



Ilex vomitoria 'Schillings'
(Yaupon Holly)

Evergreen Shrub

Height 3 - 4 ft.
Width 3 - 4 ft.
Sun Sun / Part Shade
Water Medium

Native Status: Native from Virginia to Florida, and west to Texas.

Flower: Insignificant

Description: A small leaved holly that is frequently used for informal screens, low hedging and barriers.



Sesleria autumnalis
(Autumn Moor Grass)

Cool Season Grass

Height 0.75 - 1 ft.
Width 0.5 - 1 ft.
Sun Sun / Part Shade
Water Medium / Dry

Native Status: Native to Southern Europe and the Caucasus.

Flower: Creamy / white inflorescences in summer/autumn.

Description: Clump forming ornamental grass - the soft yellow green grass emerges in spring from which small white inflorescences appear in summer. As summer turns to autumn, the inflorescences become a golden tan color. The grass maintains its habit and does not flop.



Amsonia 'Blue Ice'
(Eastern Bluestar)

Herbaceous Perennial

Height 1 - 1.5 ft.
Width 1 - 2 ft.
Sun Sun / Part Shade
Water Medium / Dry

Native Status: One of *Amsonia* 'Blue Ice's' likely parents, *A. tabernaemontana* is native from east Texas up to New York.

Flower: Clusters of star-like blue flowers appear in early spring.

Description: A likely hybrid of *Amsonia tabernaemontana*, 'Blue Ice' is a compact cultivar that can thrive in a wide variety of conditions. As well as a spring display of flowers, the foliage turns yellow / orange in autumn adding further seasonal interest.

DESIGN CONCEPT: ALTERNATE SCHEME 2 PLANT PALETTE

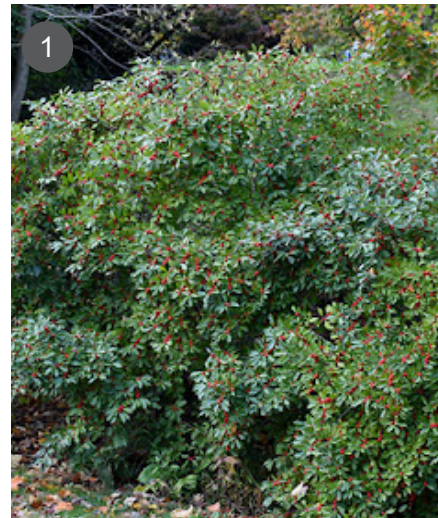

Ilex verticillata 'Nana'
(Red Sprite Winterberry) ALT A

Deciduous shrub

Height 2.5 - 3 ft.
Width 2.5 - 3 ft.
Sun Sun / Part Shade
Water Medium - Wet

Native Status: Native in eastern America, including Texas.

Flower: Inconspicuous white flowers appear in summer, with intensely red berries developing in fall and persist through winter that are attractive to wildlife.

Description: Compact cultivar of the species. The species is durable and adaptable to a multitude of landscapes.



Viburnum dentatum 'Blue Muffin'
(Arrowwood Viburnum) ALT B

Deciduous shrub

Height 3 - 5 ft.
Width 3 - 5 ft.
Sun Sun / Part Shade
Water Medium

Native Status: Native in eastern America, including east Texas.

Flower: White flowers appear in spring, with intensely blue berries developing afterwards that are attractive to wildlife.

Description: Compact cultivar of the species, with yellow/orange foliage in fall. The species is durable and adaptable to a multitude of landscapes.

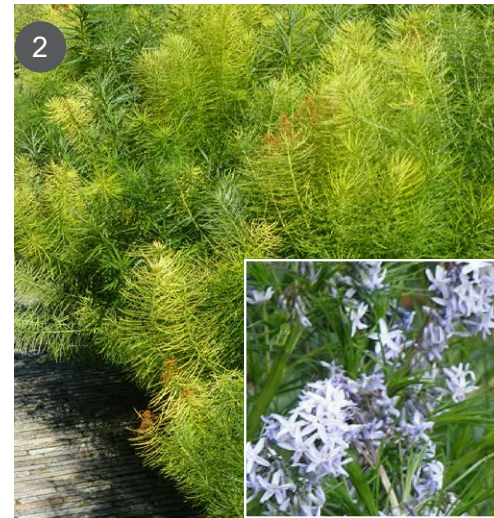

Amsonia hubrichtii
(Threadleaf Bluestar)

Deciduous Perennial

Height 2 - 3 ft.
Width 2 - 3 ft.
Sun Sun / Part Shade
Water Medium

Native Status: Native in parts of Oklahoma and Arkansas.

Flower: Light blue star-like flowers in late spring or early summer.

Description: Tactile feathery foliage emerges in spring, with blue flowers at the end of the season. By fall, foliage turns golden yellow to complement surrounding plants.

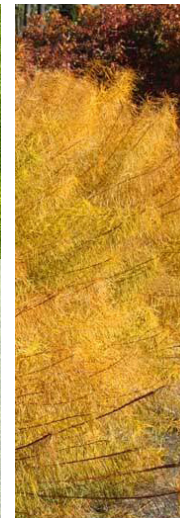

Nassella tenuissima
(Mexican Feather Grass)

Cool Season Grass

Height 0.5 - 1.5 ft.
Width 1 - 2 ft.
Sun Sun / Part Shade
Water Medium / Dry

Native Status: Native in west Texas and south through Central Mexico.

Flower: Small insignificant inflorescences in summer that can resemble feathery clouds when planted in groupings.

Description: Finely textured grass that sways with the hint of a breeze. The blades start as light green and mature to light brown in winter. Grows in open scrublands and rocky slopes and is drought tolerant.

DESIGN CONCEPT: REPRESENTATIVE BULB PALETTE



Scilla sibirica
(Siberian Squill)

Spring Flowering Bulb

Height 5 - 7 in.
Flower Early / Mid Spring



Ipheion 'White Star'
(Mexican Star)

Spring Flowering Bulb

Height 3 - 6 in.
Flower Mid Spring



Narcissus 'Las Vegas'
(Daffodil)

Spring Flowering Bulb

Height 18 - 20 in.
Flower Early / Mid Spring



Narcissus 'Mount Hood'
(Daffodil)

Spring Flowering Bulb

Height 15 - 17 in.
Flower Mid Spring



Narcissus 'Actaea'
(Daffodil)

Spring Flowering Bulb

Height 15 - 17 in.
Flower Mid / Late Spring

**Final bulb palette to be coordinated with selected planting concept.*