

# 3299 WATER STREET, NW

WASHINGTON, DC, 20007

Square 1187 Lot 0084

## SCOPE OF WORK:

New Building Signage at 3299 Water Street, NW.

## OGB REVIEW

(EXTERIOR SIGNAGE)

### RICH MARKUS ARCHITECTS

2601 P STREET, NW SECOND FLOOR WASHINGTON DC 20007

### CONTACT INFORMATION

ARCHITECT:

RICH MARKUS ARCHITECTS  
RICH MARKUS  
2601 P STREET NW,  
2ND FLOOR  
WASHINGTON DC 20007  
703.867.0454 P  
rmarkus@richmarkusarchitects.com  
jeffs@richmarkusarchitects.com

### DRAWING INDEX

ARCHITECTURAL

- |      |                            |
|------|----------------------------|
| A000 | DDOT COVER SHEET           |
| A001 | PROPOSED VIEWS             |
| A101 | SIGNAGE ELEVATIONS & NOTES |

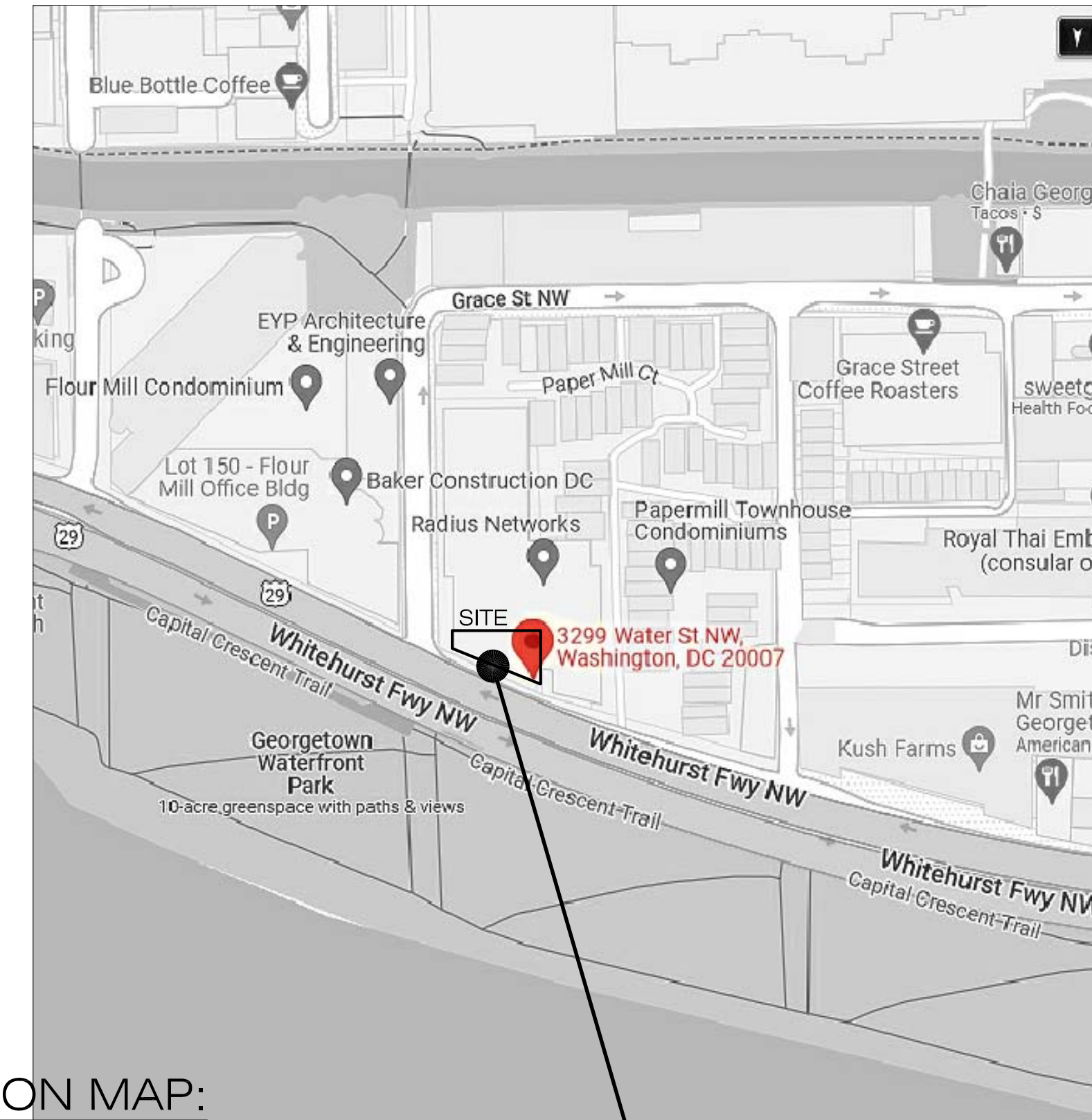
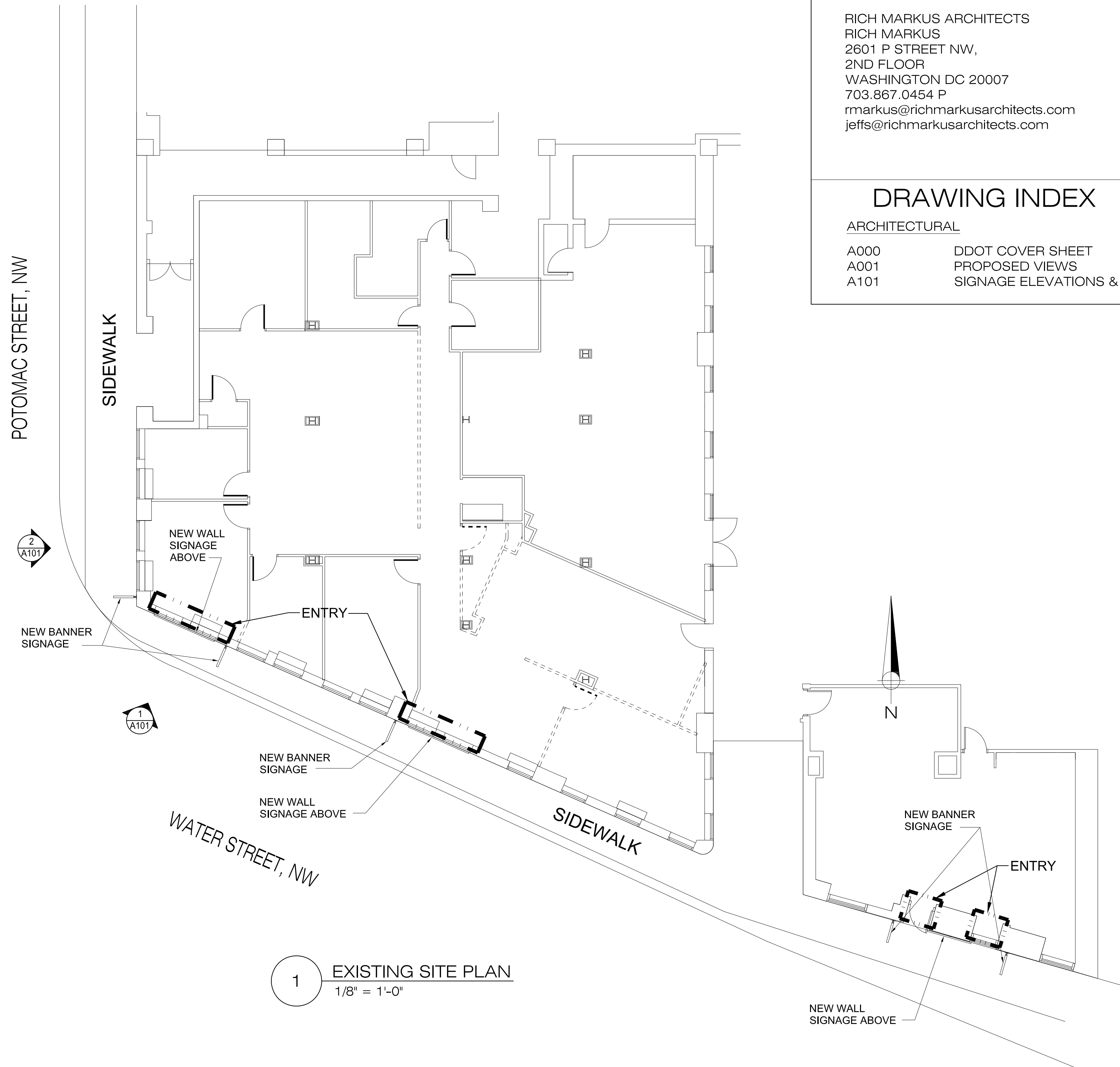

LOCATION MAP:

### VICINITY MAP



RICH MARKUS ARCHITECTS  
2601 P STREET NW, 2ND FLR  
WASHINGTON DC 20007  
202.333.2733 V 202.333.2779 FAX

3299 WATER STREET, NW  
Washington, DC 20007

OGB COVER SHEET

NO.	REVISIONS

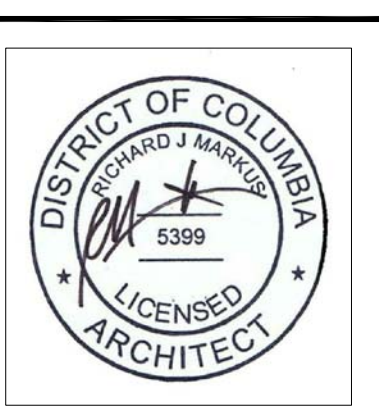

AS SHOWN SCALE

09.14.2022 ISSUE

A000  
DRAWING NUMBER

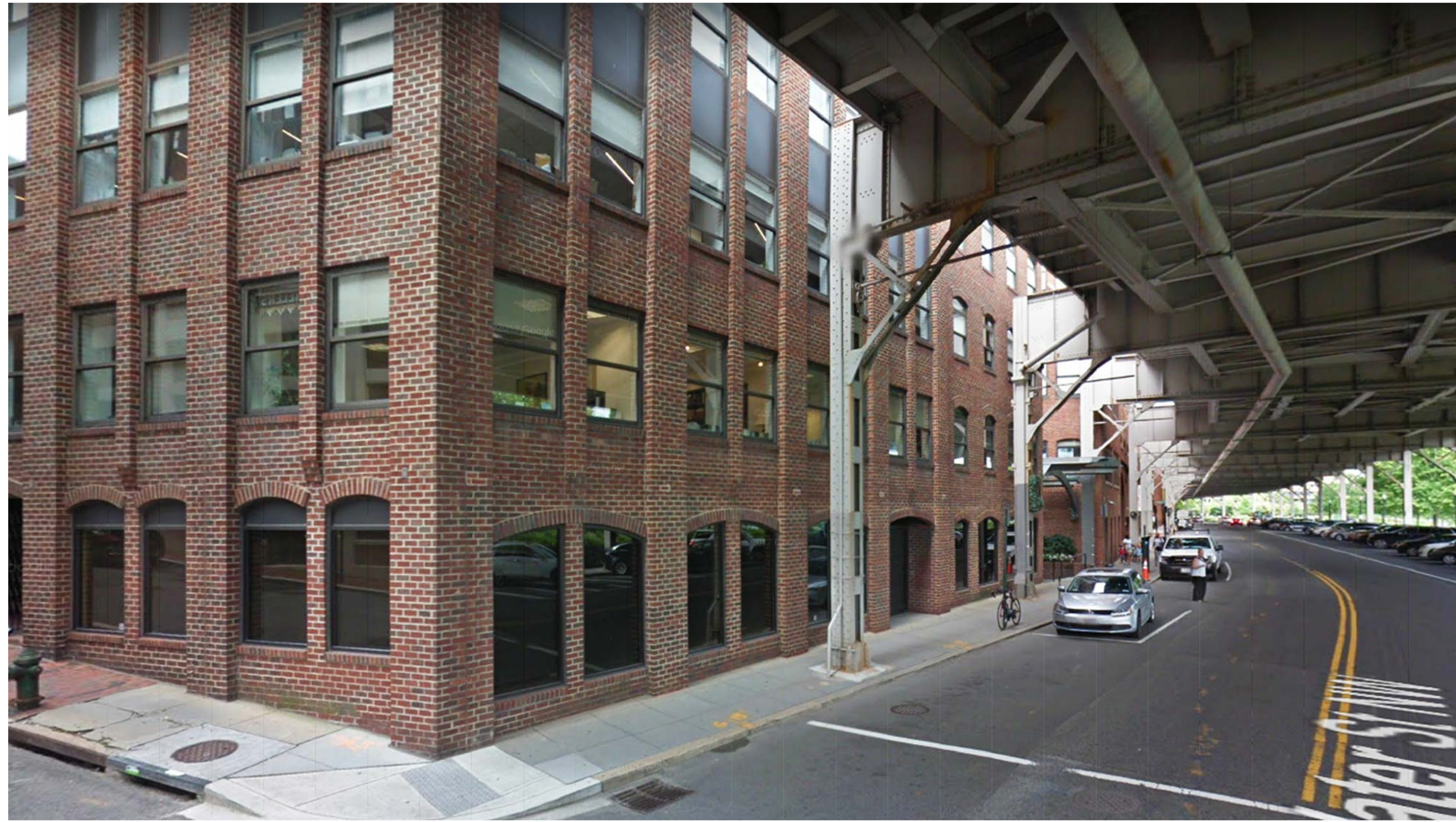

1 EXISTING  
CORNER OF POTOMAC & WATER STREET VIEW  
N.T.S.

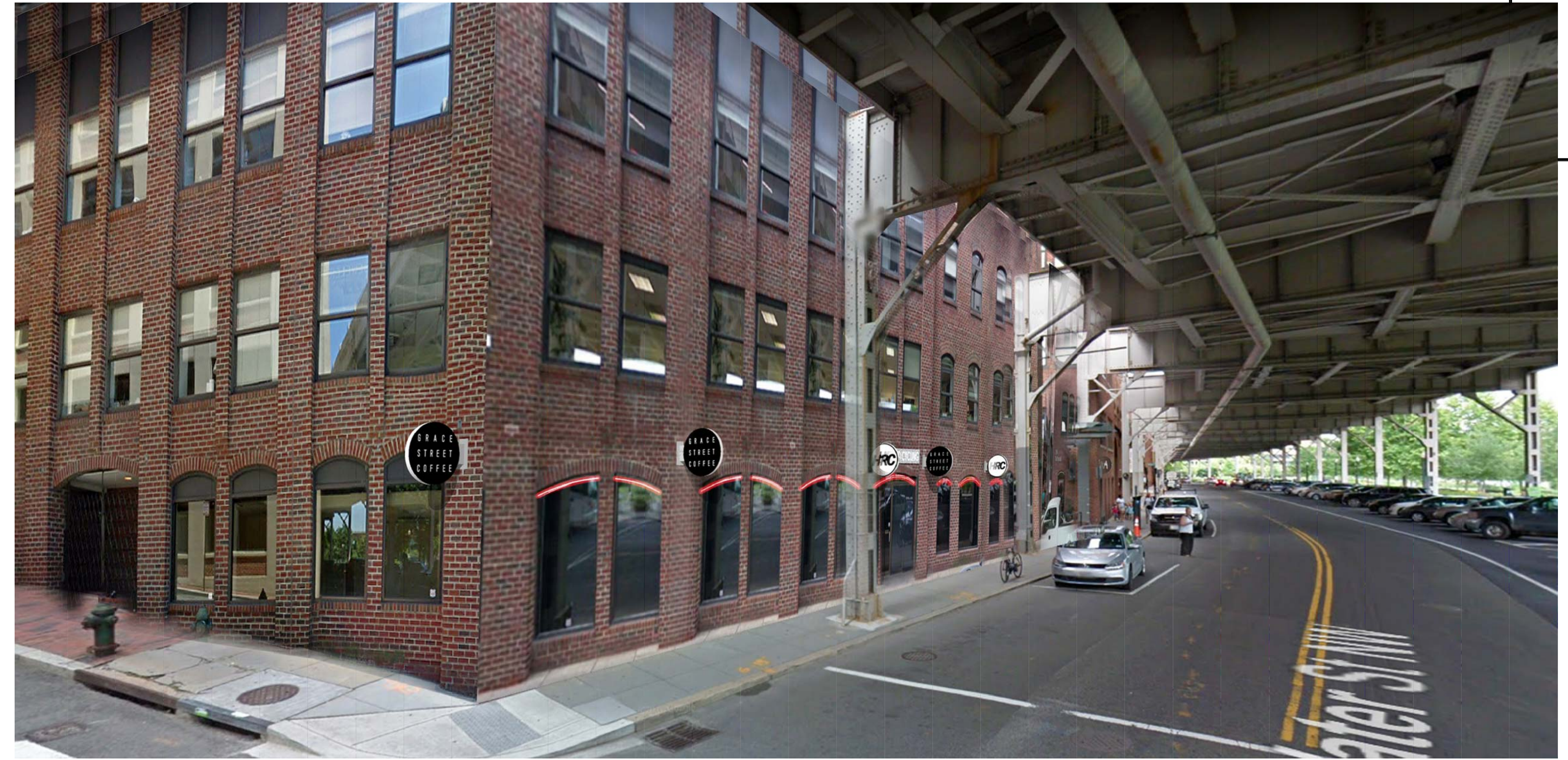

2 PROPOSED  
CORNER OF POTOMAC & WATER STREET VIEW  
N.T.S.

RICH MARKUS ARCHITECTS  
2601 P STREET NW, 2ND FLR  
WASHINGTON DC 20007  
202.333.2733 V 202.333.2779 FAX

3299 WATER  
STREET, NW  
Washington, DC 20007



FACING  
WATER STREET, NW  
ELEVATION  
(BUILDING #1)



FACING  
WATER STREET, NW  
ELEVATION  
(BUILDING #2)

3 WATER STREET VIEW  
N.T.S.

PROPOSED  
VIEWS

REVISIONS

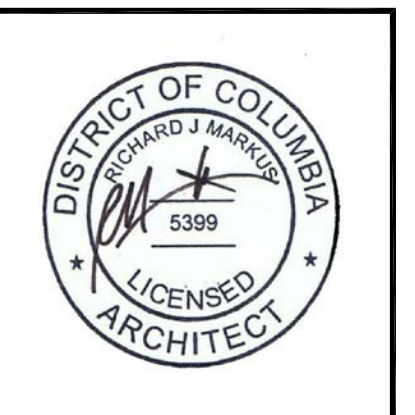

AS NOTED SCALE

09.14.2022 ISSUE

A001  
DRAWING NUMBER

KEY NOTES

- 01
- 02
- 03
- 04
- 05
- 06
- 07
- 08
- 09
- 10
- 11
- 12

CONSTRUCTION PLAN SYMBOLS

- 01 KEY NOTE- SEE NOTES ON DRAWING SHEET.
- NOT IN CONTRACT (N.I.C.)
- MASONRY INFILL
- D-01A DOOR TAG- NUMBER DESIGNATES DOOR TYPE, LETTER DESIGNATES SUB TYPE. RE: SHEET A-601 FOR DOOR SCHEDULE
- 06 PARTITION TYPE, SEE SHEET A-701
- 01 ELEVATION REFERENCE
- 02 DRAWING REFERENCE

GENERAL NOTES

- A. ALL DIMENSIONS ARE TO FACE OF FINISHED PARTITION, U.N.O. REFER TO ENLARGED PLANS AND/OR ELEVATIONS FOR ADDITIONAL DIMENSIONS AS REQUIRED.
- B. ALL DOORS SHALL BE LOCATED AT A DISTANCE OF 6" MEASURED FROM THE NEAREST ADJACENT PARTITION TO THE INSIDE EDGE OF TO ANY CONSTRUCTION, PER ANSI / ADA REQUIREMENTS.
- C. ALL LATCHSETS SHALL BE INSTALLED WITH THE LEVER AT A HEIGHT AS NOTED ON SHEET A-601. BUT IN NO CASE SHALL BE HIGHER THAN 48" A.F.F.
- D. ALL PARTITIONS SHALL BE TYPE 01 U.N.O. SEE SHEET A-701 FOR PARTITION TYPES.
- E. PROVIDE BLOCKING FOR MILLWORK AS REQUIRED FOR PROPER SUPPORT. REFER TO ELEVATIONS FOR ADDITIONAL INFO.
- F. REFER TO SHEET A-601 FOR WINDOW ELEVATIONS.

**RICH MARKUS ARCHITECTS**  
 2601 P STREET NW, 2ND FLR  
 WASHINGTON DC 20007  
 202.333.2733 V 202.333.2779 FAX

**3299 WATER STREET, NW**  
 Washington, DC 20007

**SIGNAGE ELEVATIONS & NOTES**

NO.	REVISIONS

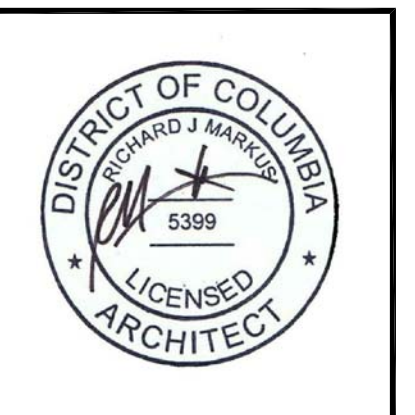

AS NOTED SCALE

09.14.2022 ISSUE

**A101**  
 DRAWING NUMBER

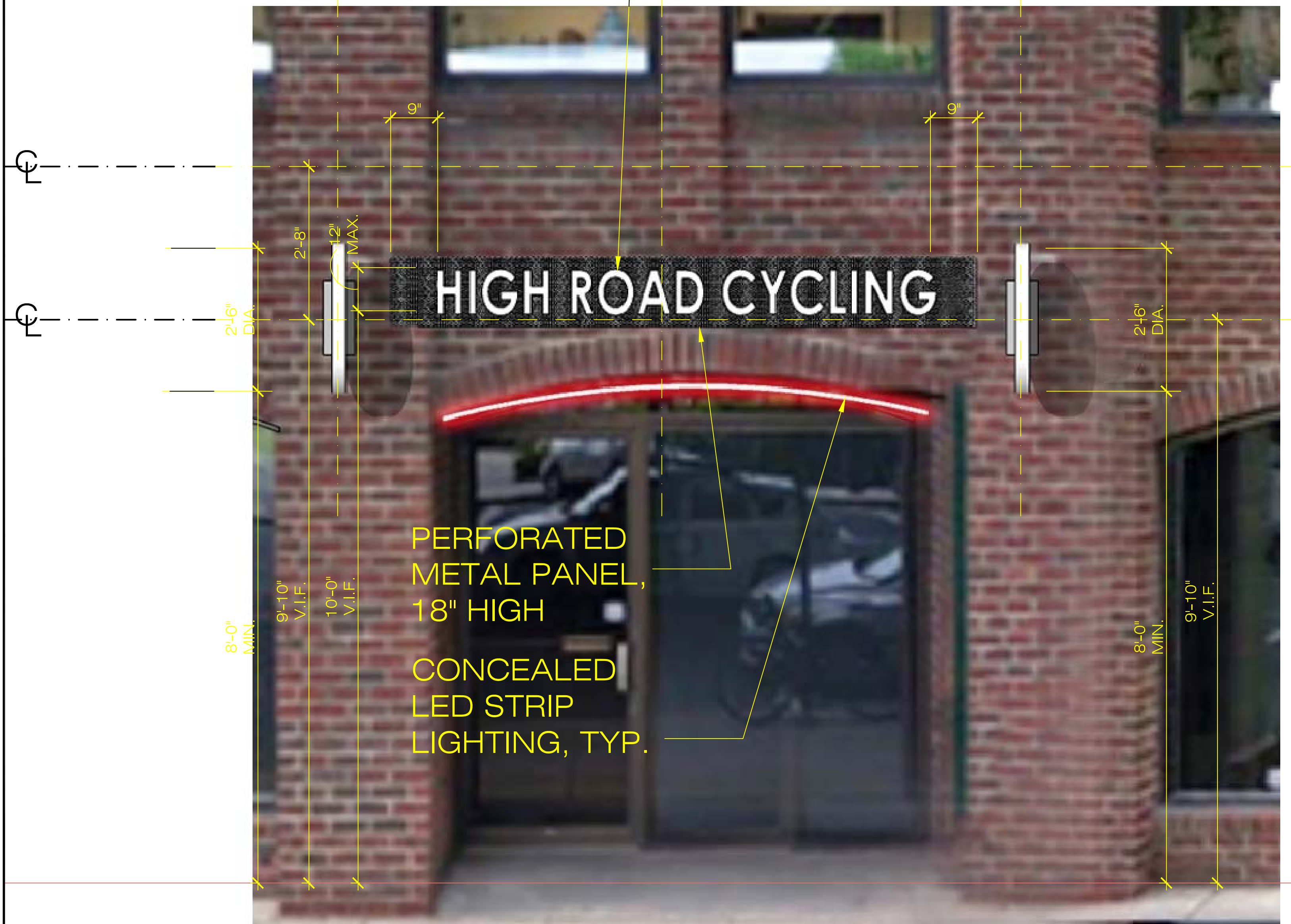
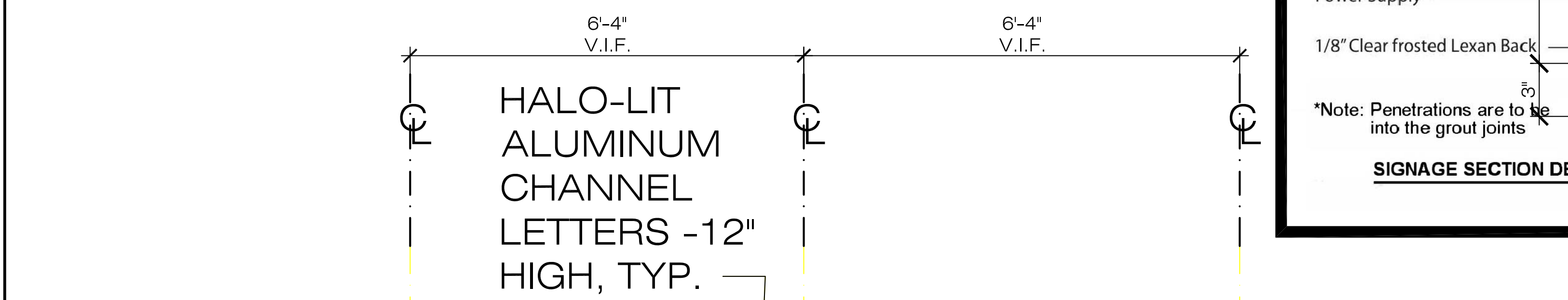
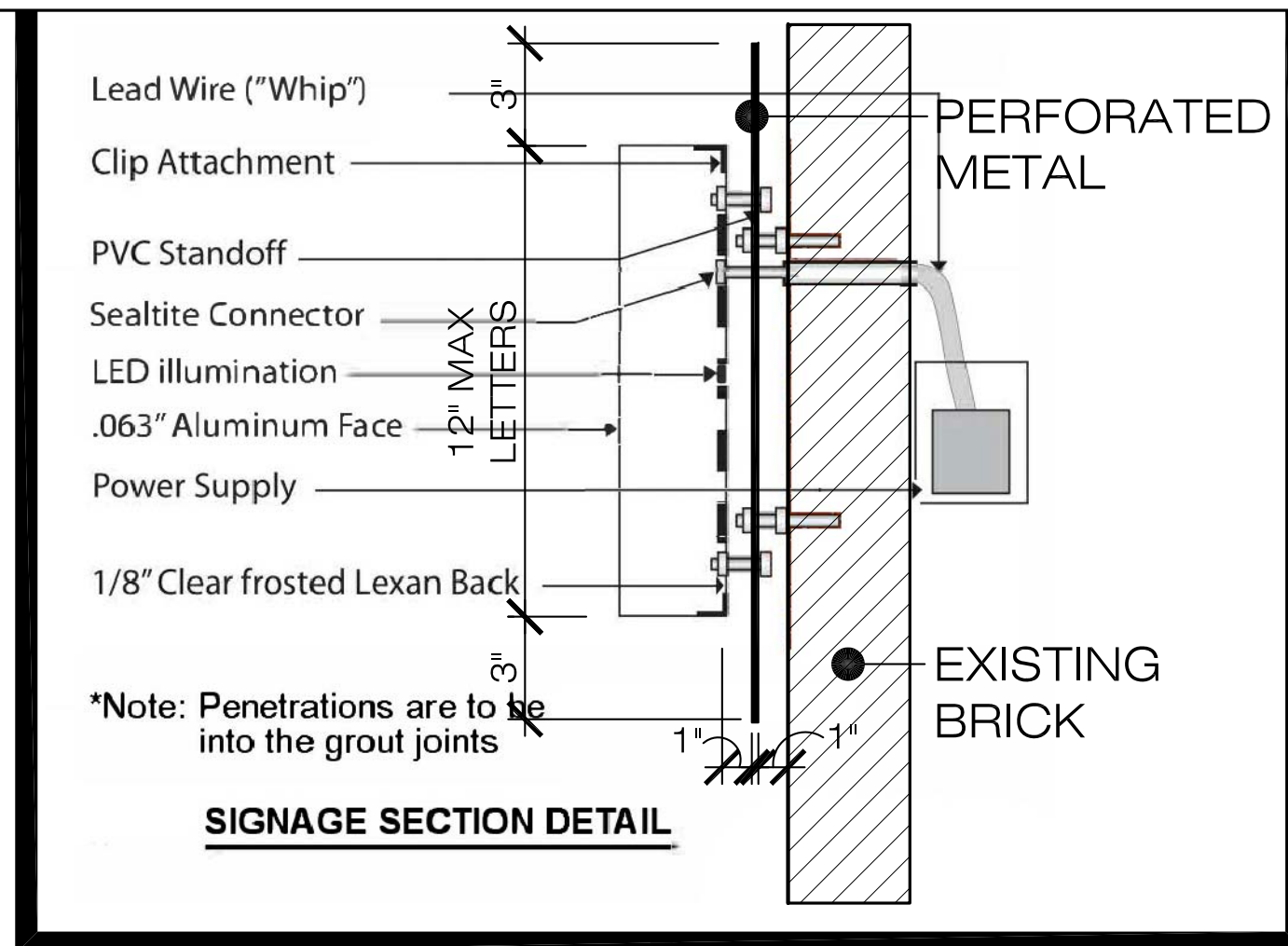

**1 WATER STREET ELEVATION**  
 1/2" = 1'-0"

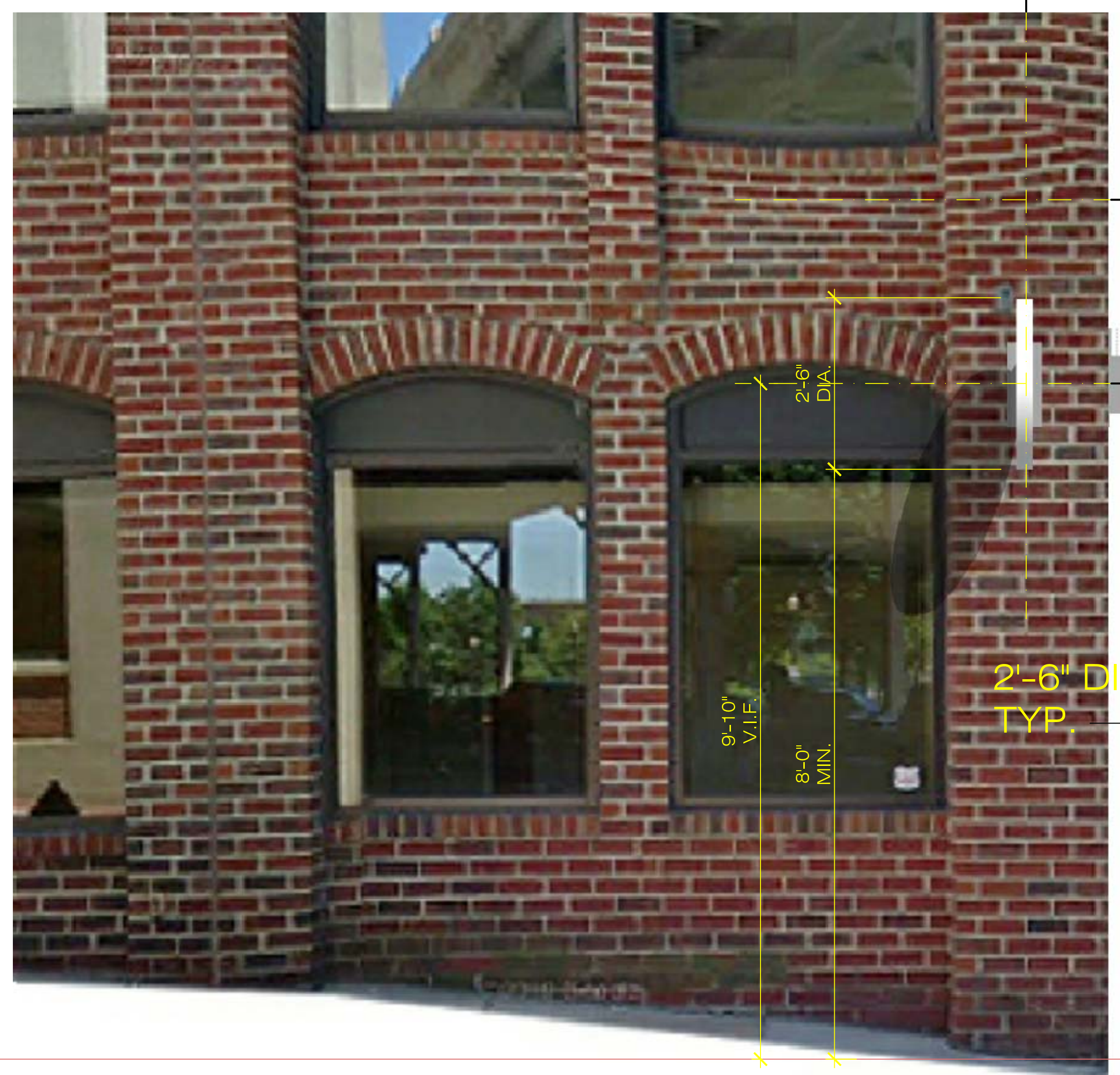

**2 POTOMAC STREET ELEVATION**  
 1/2" = 1'-0"